

Portfolio Guidance PMP

Your portfolio should be **a collection of your creative work** and is a means for you to demonstrate your abilities, interests, and potential for studying architecture. We are particularly interested in seeing **how you think** and **develop your ideas**, so please include this and any work in progress.

Submission requirements:
A3 Landscape.
PDF format.
Maximum 20MB file size.
Include your name.
Include a short personal statement.

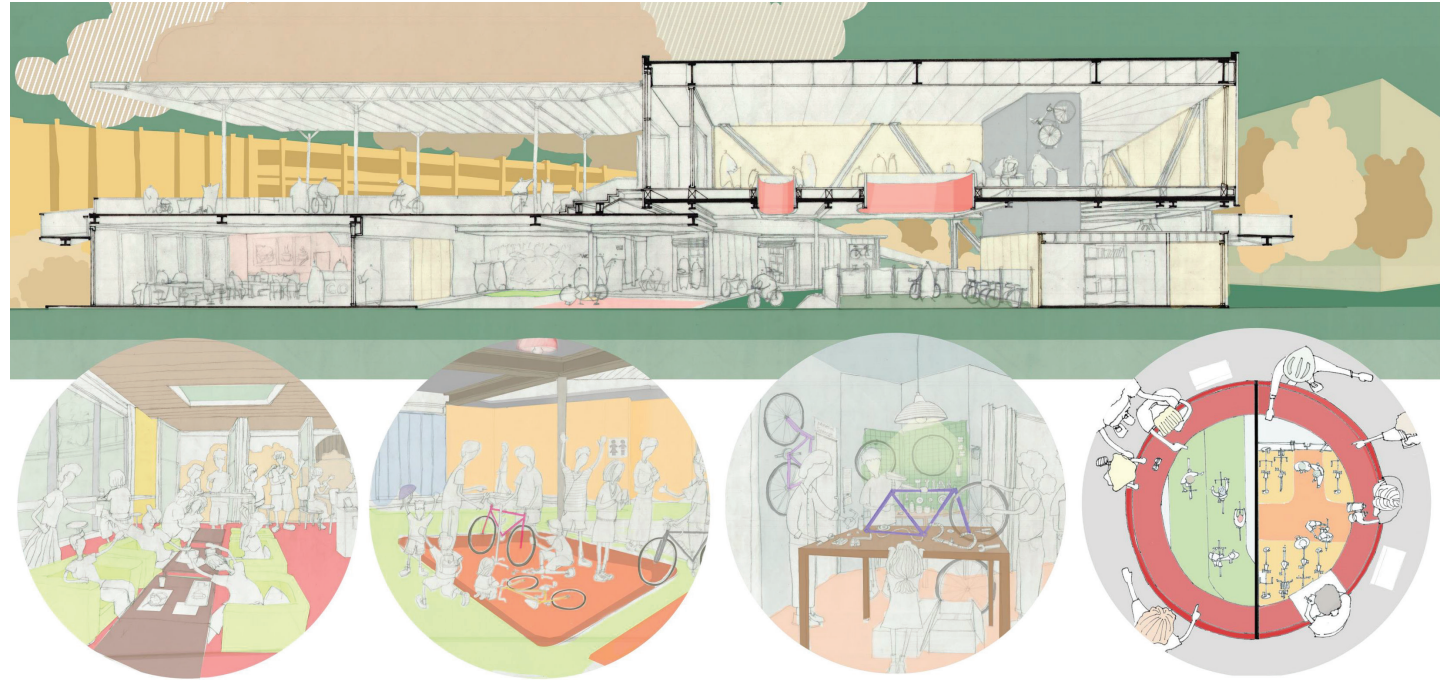
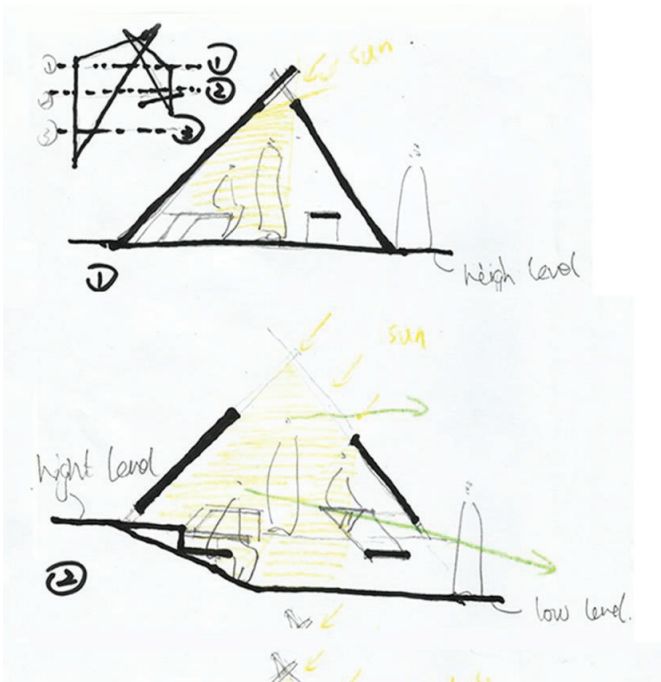

What we are looking for:

Range and Quality of Work: the portfolio should include a good variety and depth of projects and relevant exercises across the full range of the design process from early sketches to a more refined output. It should demonstrate a clear interest and commitment to the subject. You should include examples of your undergraduate projects and any relevant work experience in the field.

General Design Skills: demonstration of rigour, imagination, and competence across all aspects of architectural design. Documentation of methodical and structured design processes. Evidence of the ability to produce sophisticated, high quality design solutions. You should include highlights from sketchbooks or exploratory work that shows project development.

Research and Analytical Skills: evidence of the ability to critically reflect and analyse to a high level. Demonstration of coherent structure of thoughts, depth and quality of reasoning and evidence of research abilities.

Technical Skills: demonstration of high quality 2D and 3D manual and computer aided skills through a variety of techniques including sketching, drawing, diagramming and modelling.

Presentation: overall graphical quality of the document including clear and coherent layout, control over image hierarchy, quality and relevance of written comments.