

**INTO** »

**MANCHESTER**

IN PARTNERSHIP WITH THE UNIVERSITY OF MANCHESTER

**MANCHESTER**  
1824

The University of Manchester

**RUSSELL  
GROUP**

**INTO UNIVERSITY  
PATHWAYS FOR  
INTERNATIONAL  
STUDENTS  
2022-23**



# LEARN WITHOUT BOUNDARIES

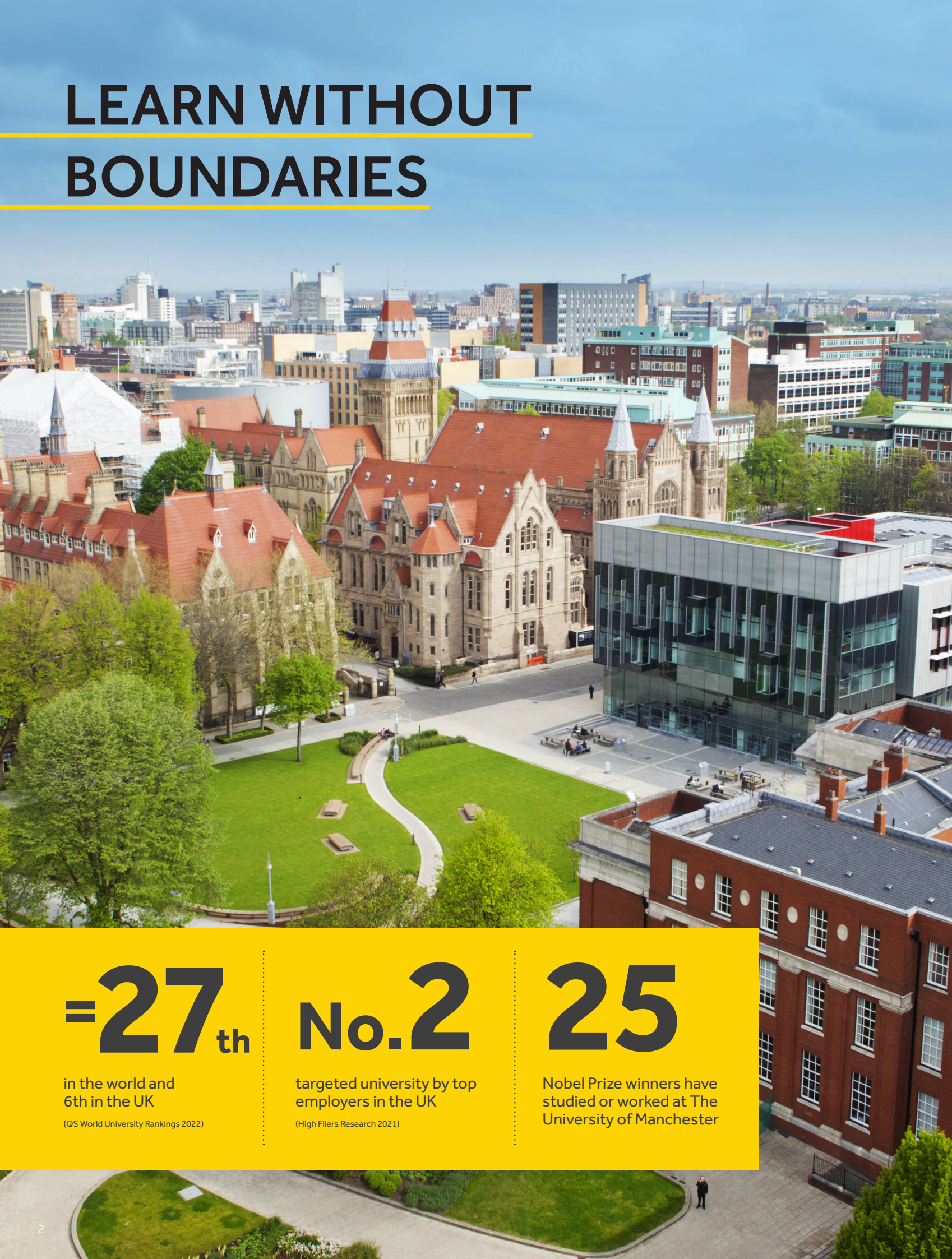

=**27<sup>th</sup>**

in the world and  
6th in the UK  
(QS World University Rankings 2022)

**No.2**

targeted university by top  
employers in the UK  
(High Fliers Research 2021)

**25**

Nobel Prize winners have  
studied or worked at The  
University of Manchester

**W**elcome to INTO Manchester, your pathway to an internationally-recognised degree from The University of Manchester. We give international students like you the opportunity to study at an historic and highly-ranked university.

At INTO Manchester, you'll study a specialist programme designed exclusively for international students and tailored to the requirements of the University. We'll help you improve your English language skills and adjust to life as a student in the UK, so when you successfully complete your pathway and meet the required grades, you can confidently progress to your degree at The University of Manchester.

You'll complete your course at our INTO Study Centre in the student-friendly city of Manchester – and with access to some key facilities on campus, you'll soon be ready to join The University of Manchester.

Choosing to study abroad is a big decision, but at INTO Manchester, we'll give you everything you need to succeed at university and beyond.

**Choose #INTOManchester and open up a lifetime of opportunities.**



## THE UNIVERSITY OF MANCHESTER'S GLOBALLY-RANKED SUBJECT AREAS

**14<sup>th</sup>**  
Pharmacy and Pharmacology\*

**17<sup>th</sup>**  
Accounting and Finance\*

**27<sup>th</sup>**  
Sociology\*

**27<sup>th</sup>**  
Chemistry\*

**28<sup>th</sup>**  
Chemical Engineering\*

**28<sup>th</sup>**  
Materials Science\*

**29<sup>th</sup>**  
Mechanical Engineering\*

**32<sup>nd</sup>**  
Business and Management\*

**48<sup>th</sup>**  
Law\*\*

\* QS World University Rankings by Subject 2021  
\*\*Times Higher Education World University Rankings by Subject 2021



# ABOUT THE UNIVERSITY



**T**he University of Manchester is among the top universities worldwide. Choose to study here and you'll become part of one of the UK's biggest student communities, making use of world-class facilities housed among a mixture of historic Victorian and modern buildings.

## Educational excellence

Prepare to study at one of the most respected institutions in the world. The University of Manchester is recognised for its high-quality education, research and academic achievements dating back almost 200 years.

This prestigious university is consistently in the top 30 in world rankings, and is currently ranked 27th in the world\*.

## Pioneering innovation

From the birth of the modern computer to the isolation of graphene, world-changing innovation is at the heart of the University. This elite Russell Group university is ranked 5th in the UK for 'research power'\*\*, with its research covering one of the largest ranges of academic areas among UK universities.

At The University of Manchester, you can:

- be taught by staff with strong links to industry
- have the chance to undertake work experience
- contribute to research and studies in your subject area
- develop skills and knowledge that will boost employability

## Join a global network of professionals

Many of the University's almost 500,000 alumni have top positions in business, politics, industry and the arts, across more than 190 countries around the world. With such a high calibre of real-world learning and an international focus, it's no wonder that 25 Nobel Prize winners have studied or worked at The University of Manchester throughout its impressive history.

## Create your future

The University of Manchester also gives you the opportunity to boost your employability skills and set yourself up for future success. You can develop career-focused skills through:

- 'Stellify' – the University's unique extracurricular scheme which involves volunteering, activities and career development opportunities
- Manchester Leadership Programme
- the University's comprehensive Careers Service

These services help The University of Manchester produce some of the most employable graduates around the world. You'll soon discover why it's the number two targeted university by top employers in the UK†.

\* QS World University Rankings 2022  
\*\* Research Excellence Framework 2014  
† High Fliers Research 2021



"Successful completion of the INTO Manchester International Foundation can lead to a wide range of undergraduate courses at The University of Manchester. This includes various courses in Business and Management, Law, Science, Engineering, Biosciences, Pharmacy and Psychology. I look forward to welcoming you here in the future."

**Fiona Brown,**  
Head of International Recruitment,  
The University of Manchester



# UNIVERSITY FACILITIES

**W**hatever you choose to study at The University of Manchester after your pathway programme at INTO Manchester, you'll benefit from a £1.75 billion investment in cutting-edge facilities and equipment. One of the biggest investments ever seen at a UK university!

## Inspiring learning spaces

You'll have access to some excellent subject-specific facilities as a student at The University of Manchester. Depending on your chosen degree, this could include:

- **Alliance Manchester Business School** – home to the Behavioural Research Laboratory and large-scale, interactive Data Visualisation Observatory
- **Manchester Engineering Campus Development** – the brand new Engineering building will be the single largest home for Engineering in the UK (due to open in 2022)
- **Specialist facilities** – including a moot court (Law), MRI scanners (Biology, Medicine and Health) and a chemical manufacturing laboratory (Science and Engineering)

## Staying healthy

Students are entitled to discounted rates at the University's sports facilities, which includes three fitness suites, two 50-metre swimming pools and many indoor courts and outdoor pitches close to campus.

The Athletic Union is made up of more than 40 sports clubs, so you also have the chance to represent the University. Other organised activities include campus sports leagues, hall sport sessions and health and fitness classes.

The city offers even more sports facilities for you to enjoy. Sportcity includes an indoor tennis centre, an athletics centre and Manchester Velodrome, while the Chill Factor is the UK's longest indoor ski slope. It's all just a short distance away!



Alliance Manchester  
Business School

Here are some of the facilities you'll have access to as an INTO Manchester student:



**Main Library**  
(one of the best-resourced academic libraries in the UK)



**Armitage and Sugden Sports Centres**  
(student discount available)



**Manchester Aquatics Centre**  
(student discount available)



**Campus Cafés and Restaurants**





# DISCOVER MANCHESTER

**G**et ready to explore one of the most exciting cities in the world, bursting with cultural events and international cuisine.



One of the  
world's most  
exciting  
cities

(Time Out Index 2019)



Credit: Marketing Manchester

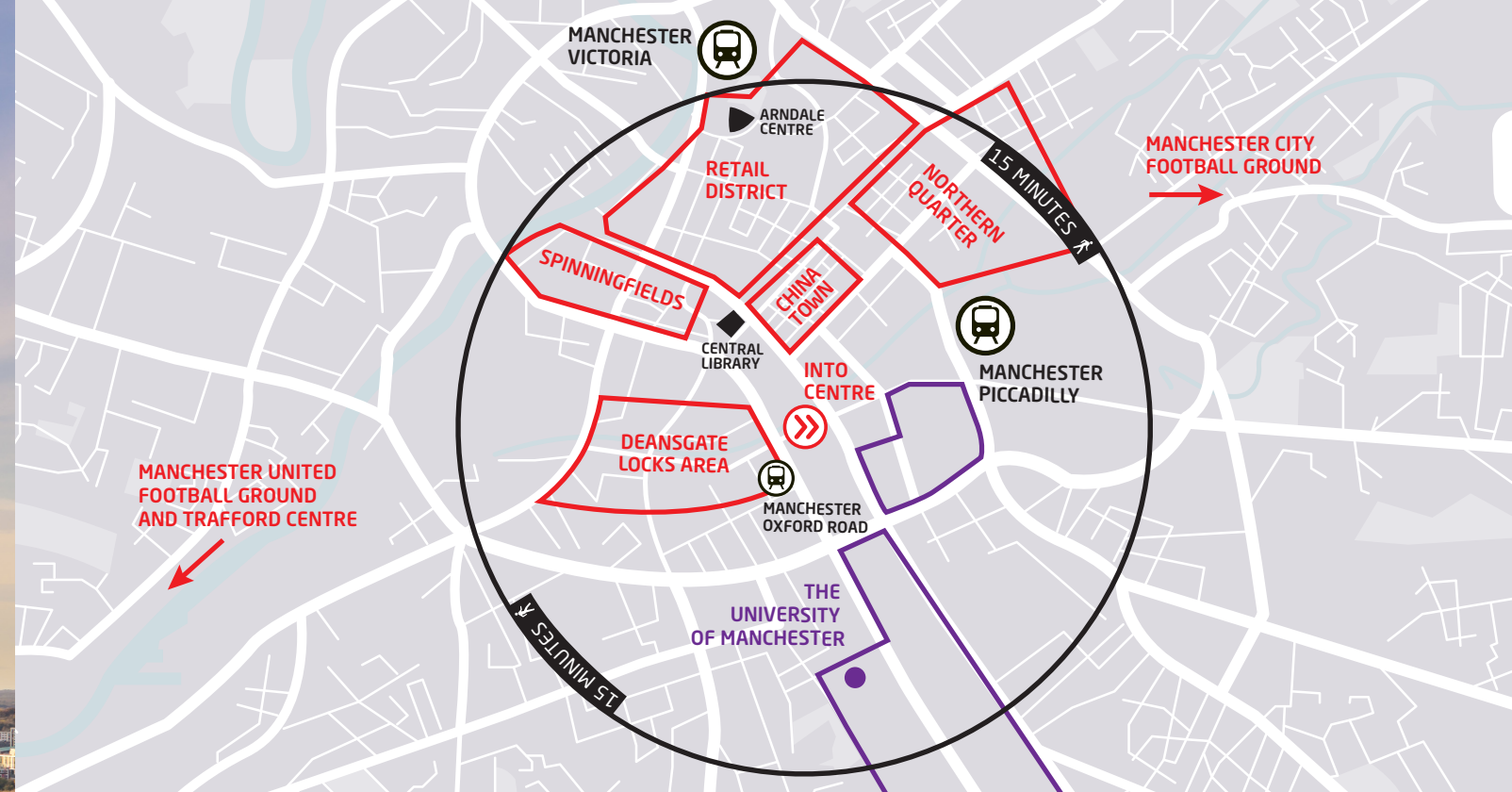

## Culture and creativity

When you live in Manchester, you'll be immersed in a lively world of music, art and fashion. You'll also have access to a bustling social calendar packed with festivals, all-day events and free activities.

The city has a number of museums and art galleries, including:

- The Whitworth Art Gallery
- Manchester Museum
- Manchester Art Gallery
- Centre for Chinese Contemporary Art
- National Football Museum
- Science and Industry Museum

The Portico, Chetham and Manchester Central Libraries are also must-sees in a city designated a **UNESCO City of Literature**\*

\* Manchester City of Literature for the UNESCO  
\*\* Statista 2020

## Gourmet to everyday

With hundreds of restaurants, there's an exciting range of quality, modern British and international cuisine available, making it easy to find foods from around the world.

From fine dining in **Spinningfields** to street food at The Makers Market, you'll find options to suit your mood and budget. **Deansgate** offers everything from tapas to traditional British food, while the cool cafés of the **Northern Quarter** are a favourite with locals.

Manchester's **Chinatown** is the second largest in Britain and has many Asian restaurants and supermarkets. There are also many restaurants and shops in **Rusholme**, offering South Asian and Middle Eastern cuisine and produce.

You'll never run out of exciting food options in Manchester!

## An iconic sporting city

Manchester is home to two of the biggest names in sport: Manchester United and Manchester City. Manchester United's ground, **Old Trafford**, is the biggest stadium in the English Premier League\*\*, while Manchester City is based at the striking **Etihad Stadium**.

Fancy getting involved? The city offers a range of state-of-the-art facilities from indoor ski-slopes to velodromes. Sport is always at the heart of Manchester.

## Getting out and about

Manchester is easy to get around on foot, by bus or by tram, and it's a great base to explore the UK – you can get to London in just two hours by train and to the Lake District in just under two hours. Manchester Airport also has flights to 199+ destinations.

Credit: Marketing Manchester



# LIFE AT THE INTO CENTRE

**A**re you ready to live and learn in one of the UK's biggest\* and best\*\* student cities? With modern facilities in a historic building, an exciting programme of activities and a team of friendly staff, INTO Manchester has it all!

## Your Study Centre

The INTO Manchester Centre offers you the chance to study in one of the most exciting and diverse cities in the world. Located in Bridgewater House, an impressive Edwardian era building, the Centre is right in the heart of bustling Manchester. Most of your classes will take place here, and you'll find everything you need to study and socialise in one location.

Our academic programmes here are taught in a similar way to what you'll experience at university, so that you'll be ready when you progress. INTO Manchester's learning Centre includes:

- 49 classrooms featuring digital whiteboards
- well-equipped computing suites
- free Wi-Fi and internet access throughout
- 24/7 access to our virtual learning environment to download resources
- a Learning Resource Centre with a wide range of online journals, books and excellent study materials
- silent study areas

If you want a break between classes, you can relax in the break-out spaces and play table football with friends, eat in the communal cafeteria on-site, or head out to the many cafés and shops on your doorstep. You'll soon feel right at home!

## Supporting you

Studying in another country can be a big adjustment, and we're here to help you. Our friendly Student Services team will help you with accommodation and visa support, and the orientation programme in your first week will cover everything from opening a bank account to getting around the city.

Our experienced teaching staff will help you to understand the UK higher education system. We operate an open-door policy for most academic staff rooms and hold optional revision classes for each subject during examination periods. You'll also be allocated a Personal Tutor upon arrival.

## Your safety is our priority

There's a 24-hour telephone helpline if you need to speak to someone out of office hours. If you're under 18, we offer extra support that includes airport pickup and checking on you each day at the student residence. You'll also receive a dedicated person to contact to ensure your wellbeing and receive a copy of our code of conduct, which you must follow; especially outside of class when you'll be unsupervised. For more information, please visit: : [www.intostudy.com/manchester/terms](http://www.intostudy.com/manchester/terms)



"We can't wait to welcome you to the dynamic city of Manchester and help you settle into life in the UK. We have a team of experienced staff to help you with both academic matters and day-to-day living so you can concentrate on your studies and make the most of your time with us."

**Dawn Abbott,**  
Centre Director

# YOUR HOME FROM HOME

INTO Manchester's safe student accommodation options enable you to live as part of a vibrant student community, or you can immerse yourself in British family life with a homestay experience. You decide!

## En suite student residences

Just a short walk from the INTO Centre and close to The University of Manchester, your accommodation has a central location which means you'll be close to many restaurants, cafés and shops.

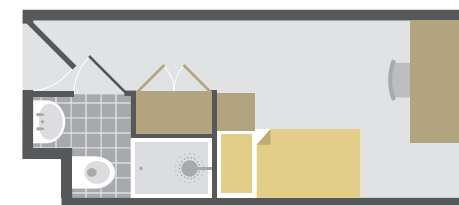

Example room layout

- En suite bathroom
- Communal areas
- Laundry facilities
- Accepts under 18s
- 24/7 staff
- Wi-Fi

**For full details of our accommodation options, visit:**

[www.intostudy.com/manchester/accommodation](http://www.intostudy.com/manchester/accommodation)

INTO Manchester aims to provide the accommodation requested. However, there may be occasions when INTO Manchester is unable to provide the requested accommodation and reserves the right to offer an alternative type of accommodation instead. The price for any alternative accommodation may differ and will be confirmed to students at the time of their offer.

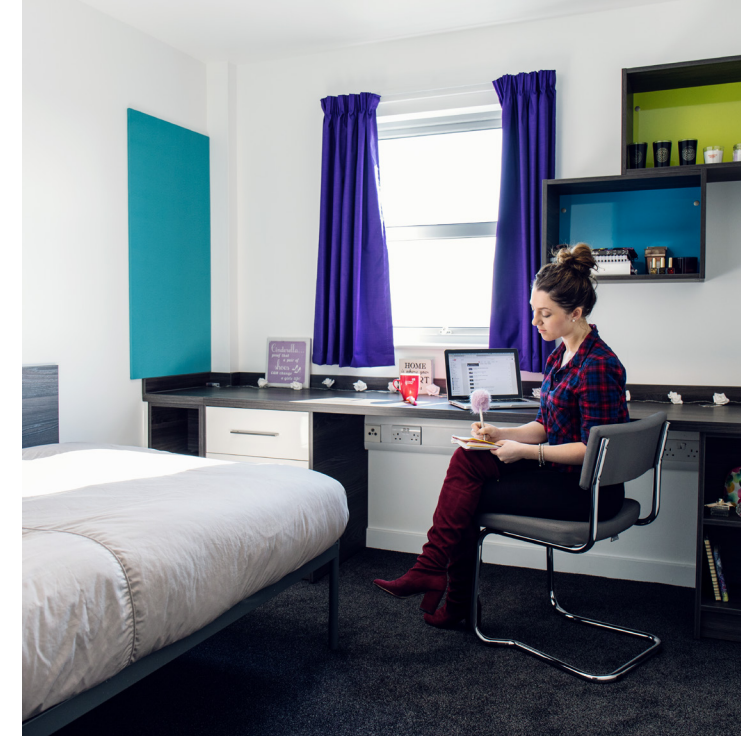

## Supporting you

In all the residences, you'll find staff available 24/7 to offer support, and we'll also provide you with a 24-hour emergency helpline telephone number. If you're under 18 and living in INTO managed accommodation, we offer extra support and will check in on you each day at the student residence where you live.

## Homestay

This is a unique opportunity to experience British life and culture first hand. You'll have a private room in a carefully selected host's home, sharing mealtimes and living spaces.





# Choosing your course

Prepare for your university degree with our tailored, academic pathway programmes. You'll benefit from university-style teaching for subject-based modules and high academic standards. Then, when it comes to progressing to your chosen degree, we'll support you with your university application.





Progress to Year 1 of an undergraduate degree at The University of Manchester

Start date

3 term: Sep or Jan  
4 term: Sep or Jun

English language entry requirements\*

3 term: UKVI IELTS 5.5 (with a minimum of 5.5 in writing) or equivalent

4 term: UKVI IELTS 5.0 (with a minimum of 5.0 in writing and no less than 4.5 in any subskill) or equivalent

Age requirement

16 years and above\*\*

Start date

3 term: Sep  
4 term: Sep or Jun

English language entry requirements\*

3 term: UKVI IELTS 5.5 (with a minimum of 5.5 in writing) or equivalent

4 term: UKVI IELTS 5.0 (with a minimum of 5.0 in writing and no less than 4.5 in any subskill) or equivalent

Age requirement

16 years and above\*\*

\* If you do not meet the minimum English language requirements, you should apply for our Academic English course. See page 18 for more information.

\*\* All students commencing courses on a published September start date must be 17 years old by 31 December of that calendar year. For all other start dates, students must be 17 years old on the published start date of the programme.

# International Foundation

## Humanities and Social Sciences - FHSS



Progress to **1 of 60+** degrees. **Scan the QR code** to find out more.

- › Attend weekly drop-in sessions with a Link Tutor from the University.
- › Practise professional presentation skills through assessed group work.
- › Build confidence constructing academic arguments, learn how to write effective essays, and correctly research and reference academic sources.
- › Specialist progression degrees include Accounting and Finance, International Relations, and Management.

What will I study?

English for Academic Purposes and Study Skills  
Information Communication Technologies (ICT)\*

3 out of 4\*\*:

Business Studies  
Economics  
Mathematics  
Global Studies

\* Compulsory but non credit bearing

\*\* Please note that the choice of subjects will depend on your chosen degree programme. Some subject combinations may not be available. Modules offered are subject to change.

## Maths and Computer Science - FMCS



Progress to **1 of 10+** degrees. **Scan the QR code** to find out more.

- › Visit the University's Department of Mathematics or Computer Science to gain an insight into different degree programmes.
- › Practise academic writing skills.
- › Specialist progression degrees include Actuarial Science and Mathematics, Computer Science, and Mathematics and Statistics.

What will I study?

English for Academic Purposes and Study Skills  
INTO Essentials\*  
Manchester University Link Tutors' Award\*

3 out of 4\*\*:

Chemistry  
Further Mathematics  
Mathematics  
Physics

\* Compulsory but non credit bearing

\*\* Please note, modules are allocated depending on your chosen degree programme. Some subject combinations may not be available.

# International Foundation

## Mechanical and Electrical Engineering- FMEE



Progress to **1 of 15+** degrees. **Scan the QR code** to find out more.

- › Learn to write lab reports.
- › Prepare for degrees accredited by the Institution of Mechanical Engineers and the Institution of Engineering and Technology.
- › Specialist progression degrees include Electrical and Electronic Engineering, and Mechatronic Engineering.

What will I study?

English for Academic Purposes and Study Skills  
INTO Essentials\*  
Manchester University Link Tutors' Award\*

3 out of 4\*\*:

Chemistry  
Further Mathematics  
Mathematics  
Physics

\* Compulsory but non credit bearing

\*\* Please note that the choice of subjects will depend on your chosen degree programme. Some subject combinations may not be available. Modules offered are subject to change.

## Pharmacy - FPH



Progress to **MPharm Pharmacy**. **Scan the QR code** to find out more.

- › Gain practical experience through laboratory work.
- › MPharm Pharmacy degree is accredited by the General Pharmaceutical Council.
- › Prepare to gain real life experience during you degree in pharmacy departments and wards.

What will I study?

Chemistry  
English for Academic Purposes and Study Skills  
Information Communication Technologies (ICT)\*

3 out of 4\*\*:

Biology  
Further Mathematics  
Mathematics  
Physics

\* Compulsory but non credit bearing

\*\* Please note that the choice of subjects will depend on your chosen degree programme. Some subject combinations may not be available.

Progress to Year 1 of an undergraduate degree at The University of Manchester

Start date

3 term: Sep or Jan  
4 term: Sep or Jun

English language entry requirements\*

3 term: UKVI IELTS 5.5 (with a minimum of 5.5 in writing) or equivalent

4 term: UKVI IELTS 5.0 (with a minimum of 5.0 in writing and no less than 4.5 in any subskill) or equivalent

Age requirement

16 years and above\*\*

Start date

3 term: Sep or Jan

English language entry requirements\*

3 term: UKVI IELTS 6.0 (with a maximum of one subskill at 5.5 and all others at 6.0 or above) or equivalent

Age requirement

16 years and above\*\*

**Note:** progression to any degree from the Pharmacy pathway is subject to interview.

Prepare to progress to a degree at The University of Manchester:



in the world for Pharmacy and Pharmacology

(QS World University Rankings by Subject 2021)

\* If you do not meet the minimum English language requirements you should apply for our Academic English course. See page 18 for more information.

\*\* All students commencing courses on a published September start date must be 17 years old by 31 December of that calendar year. For all other start dates, students must be 17 years old on the published start date of the programme.



Progress to Year 1 of an undergraduate degree at The University of Manchester

Start date

3 term: Sep or Jan  
4 term: Sep or Jun

English language entry requirements\*

3 term: UKVI IELTS 5.5 (with a minimum of 5.5 in writing) or equivalent

4 term: UKVI IELTS 5.0 (with a minimum of 5.0 in writing and no less than 4.5 in any subskill) or equivalent

Age requirement

16 years and above\*\*

Start date

3 term: Sep or Jan

English language entry requirements\*

3 term: UKVI IELTS 5.5 (with a minimum of 5.5 in writing) or equivalent

Age requirement

16 years and above\*\*

\* If you do not meet the minimum English language requirements, you should apply for our Academic English course. See page 18 for more information.

\*\* All students commencing courses on a published September start date must be 17 years old by 31 December of that calendar year. For all other start dates, students must be 17 years old on the published start date of the programme.

# International Foundation

## Physical and Natural Sciences - FPN



Progress to **1 of 45+** degrees. **Scan the QR code** to find out more.

- › Enhance your understanding of a range of scientific topics, discovering solutions to global issues.
- › Gain practical experience in university-style labs..
- › Specialist progression degrees include Chemistry with Medicinal Chemistry, Earth and Planetary Sciences, and Materials Science.

What will I study?

English for Academic Purposes and Study Skills  
INTO Essentials\*  
Manchester University Link Tutors' Award\*

3 out of 5\*\*:

Biology  
Chemistry  
Further Mathematics  
Mathematics  
Physics

\* Compulsory but non credit bearing

\*\* Please note, modules are allocated depending on your chosen degree programme. Some subject combinations may not be available.

## Psychology - FPS



Progress to **BSc Psychology**. **Scan the QR code** to find out more.

- › Investigate the study of sleep, nonverbal behaviour, eye movements and decision-making through lab work.
- › BSc (Hons) Psychology is accredited for membership of the British Psychological Society.

What will I study?

English for Academic Purposes and Study Skills  
Information Communication Technologies (ICT)\*

3 out of 8\*\*:

|                     |                     |
|---------------------|---------------------|
| Biology             | Further Mathematics |
| Business Management | Mathematics         |
| Chemistry           | Physics             |
| Economics           | Global Studies      |

\* Compulsory but non credit bearing

\*\* Please note that the choice of subjects will depend on your chosen degree programme. Some subject combinations may not be available.

# Popular degree programmes

An International Foundation pathway programme can lead to a wide variety of degree programmes at The University of Manchester, including:

**Accounting and Finance BAEcon (Hons)**

- Learn all the skills you need to become a chartered accountant in this new degree programme, launched in partnership with PwC.
- Boost your employability skills with a paid professional experience year.

**Chemical Engineering BEng (Hons)**

- Prepare for a challenging-yet-rewarding career as a Chemical Engineer – the highest paid graduates in the Engineering field.
- Manchester is the 'birthplace' of Chemical Engineering as an academic subject, and the University is home to the UK's largest department of its kind.

**Information Technology Management for Business BSc (Hons)**

- Developed in collaboration with global business employers, this degree teaches skills that cover the challenging 'middle ground' of business and IT.
- You'll complete a paid year-long industrial placement after your second year, giving you a unique insight to real-world business challenges.

**Optometry BSc (Hons)**

- This degree will allow you to understand the scientific principles of the human eye, including properties of light, eye anatomy and vision processing.
- You'll make use of the University's £4 million optometry facilities, with work placements available at one of Europe's largest eye hospitals.

**Pharmacy MPharm**

- Accredited by the General Pharmaceutical Council, this degree will give you the knowledge and practical skills you need to enter the pharmacy profession.
- The University of Manchester was the first university in the world to award Pharmacy degrees, with an impressive 120+ years of teaching to date.

**Psychology BSc (Hons)**

- This degree offers a scientific look at human behaviour and the mind, teaching you to evaluate psychological theories and develop your own.
- It is ranked in the top 10 psychology degrees in the UK, and holds accreditation from the British Psychology Society.



"One of my subjects, Further Maths, is a subject I didn't have at home in Pakistan. Studying this has really prepared me well for entry to university as it's very similar to the subjects I will cover as part of the degree programme I am progressing to at The University of Manchester."

Asad, Pakistan  
Progressed to the Department of Computer Science at The University of Manchester



# Progression degree overview table

There are more than 100 progression degree options at The University of Manchester. You can progress to any of these from one of our INTO Manchester pathway programmes. Below is a selection of some of the most popular. See pages 12–15 for more details on the pathways.

## International Foundation progression

| Degree   | Pathway(s)  | Specific requirements   | English level   | Final grade |
|--|-------------|---|---|-------------|
| Accounting BSc (Hons)  | FHSS        | Maths and any two from Politics, Economics and Business & Management                              | A with A in Speaking and Listening and no component below B | AAA         |
| Accounting and Finance BAEcon (Hons)                                   | FHSS        | None  | A   | AAA         |
| Actuarial Science and Mathematics BSc (Hons)                           | FMCS        | A* Maths  | B with B in Writing and no component below C                | A*AA        |
| Aerospace Engineering BEng (Hons)*                                     | FACCE       | Maths and Physics   | B   | AAA         |
| Architecture BA (Hons)   | FHSS        | A mixture of Arts/Humanities and Science subjects. Submission of a satisfactory digital portfolio | B with B in Writing and no component below C                | AAA         |
| Biochemistry BSc (Hons)*   | FB          | AA in Chemistry and another science subject (preferably Biology), grade B in a 3rd subject        | B with no component below B                                 | AAB         |
| Biology BSc (Hons)   | FB          | AA in two sciences (preferably Biology and Chemistry), grade B in a 3rd subject                   | B with no component below B                                 | AAB         |
| Biomedical Sciences BSc (Hons)*  | FB          | AA in two sciences (preferably Biology and Chemistry), grade B in a 3rd subject                   | B with no component below B                                 | AAB         |
| Biotechnology BSc (Hons)*  | FB          | AA in two sciences (preferably Biology and Chemistry), grade B in a 3rd subject                   | B with no component below B                                 | AAB         |
| Chemical Engineering BEng (Hons)*                                      | FACCE       | Maths and Chemistry or Physics  | B   | AAA         |
| Chemistry BSc (Hons)*  | FPN         | Chemistry and at least one other science or mathematics subject                                   | B   | AAA         |
| Civil and Structural Engineering MEng (Hons)                           | FACCE       | Maths and Physics   | B   | AAA         |
| Civil Engineering BEng* (Hons)   | FACCE       | Maths and Physics   | B   | AAB         |
| Computer Science BSc (Hons)* **  | FMCS        | Maths and Physics or Further Maths  | A*  | A*A*A*      |
| Criminology BA (Hons)  | FHSS        | None  | A   | AAB         |
| Earth and Planetary Sciences BSc (Hons)*                               | FPN         | At least one science subject  | B   | ABB         |
| Economics BSc (Hons)   | FHSS        | Maths   | B with B in Speaking and Writing and no component below C   | AAA         |
| Economics and Finance BAEcon (Hons)                                    | FHSS        | None  | A   | AAA         |
| Economics and Politics BAEcon (Hons)                                   | FHSS        | None  | B with B in Speaking and Writing and no component below C   | AAA         |
| Electrical and Electronic Engineering BEng (Hons)*                     | FMEE        | Maths and either Physics or Further Maths   | A   | A*AA        |
| Electronic Engineering BEng (Hons)*                                    | FMEE        | Maths and either Physics or Further Maths   | A   | A*AA        |
| Environmental Science BSc (Hons)*                                      | FPN         | At least one science subject  | B   | ABB         |
| Fashion Buying and Merchandising BSc (Hons)                            | FPN or FHSS | None  | C with no component below D                                 | AAB         |
| Fashion Management BSc (Hons)  | FPN or FHSS | None  | C with no component below D                                 | AAB         |
| Fashion Marketing BSc (Hons)   | FPN or FHSS | None  | C with no component below D                                 | AAB         |
| Finance BAEcon (Hons)  | FHSS        | None  | A   | AAA         |
| Genetics BSc (Hons)*   | FB          | AA in two sciences (preferably Biology and Chemistry), grade B in a 3rd subject                   | B with no component below B                                 | AAB         |
| Geography BA (Hons)  | FPN or FHSS | None  | B with B in Writing and speaking and no component below C   | AAB         |
| Immunology BSc (Hons)*   | FB          | AA in two sciences (preferably Biology and Chemistry), grade B in a 3rd subject                   | B with no component below B                                 | AAB         |
| Information Technology Management for Business BSc (Hons)              | FHSS        | Maths   | A with A in Speaking and Writing and no component below B   | AAA         |
| International Business, Finance and Economics BSc (Hons)               | FHSS        | Maths   | A with A in Speaking and Writing and no component below B   | AAA         |
| International Disaster Management and Humanitarian Response BSc (Hons) | FHSS        | None  | A and no component below B                                  | AAB         |
| Law LLB (Hons)   | FHSS        | None  | A   | A*AA        |
| Life Sciences BSc (Hons)   | FB          | AA in two sciences (preferably Biology and Chemistry), grade B in a 3rd subject                   | B with no component below B                                 | AAB         |
| Management BSc (Hons)  | FHSS        | Maths   | A with A in Speaking and Listening and no component below B | AAA         |

## Grade equivalents table

| Grade | %      | Academic modules | EAP module        |
|-------|--------|------------------|-------------------|
|       |        | NCUK points      | IELTS equivalency |
| A*    | >80%   | 56 points        | 7.5               |
| A     | 70-79% | 48 points        | 7                 |
| B     | 60-69% | 40 points        | 6.5               |
| C     | 50-59% | 32 points        | 6                 |
| D     | 40-49% | 24 points        | 5.5               |
| E     | 35-39% | 16 points        | 5                 |
| U     | <35%   | -                | -                 |

100+ progression degree options

| Degree  | Pathway(s)   | Specific requirements  | English level   | Final grade |
|---|--------------|--|---|-------------|
| Management (Accounting and Finance) BSc (Hons)                    | FHSS         | Maths  | A with A in Speaking and Listening and no component below B | AAA         |
| Management (Human Resources) BSc (Hons)                           | FHSS         | Maths  | A with A in Speaking and Listening and no component below B | AAA         |
| Management (Innovation, Strategy and Entrepreneurship) BSc (Hons) | FHSS         | Maths  | A with A in Speaking and Writing and no component below B   | AAA         |
| Management (International Business Economics) BSc (Hons)          | FHSS         | Maths  | A with A in Speaking and Writing and no component below B   | AAA         |
| Management (Marketing) BSc (Hons)                                 | FHSS         | Maths  | A with A in Speaking and Writing and no component below B   | AAA         |
| Materials Science and Engineering BSc (Hons)*                     | FPN          | Two subjects from Maths, Physics and Chemistry   | C with no component below D                                 | AAB         |
| Mathematics BSc (Hons)*   | FMCS or FHSS | A* Maths   | B with B in Writing and no component below C                | A*AA        |
| Mathematics and Physics BSc (Hons)*                               | FMCS         | A* in both Physics and Maths   | C   | A*A*A       |
| Mathematics and Statistics BSc (Hons)*                            | FMCS or FHSS | A* in Maths  | B with B in Writing and no component below C                | A*AA        |
| Mathematics with Finance BSc (Hons)                               | FMCS or FHSS | A* in Maths  | B with B in Writing and no component below C                | A*AA        |
| Mechanical Engineering BEng (Hons)*                               | FMEE         | Maths and Physics  | B   | AAA         |
| Mechatronic Engineering BEng (Hons)*                              | FMEE         | Maths and either Physics or Further Maths  | A   | A*AA        |
| Medical Biochemistry BSc (Hons)*                                  | FB           | AA in Chemistry and another science subject (preferably Biology), grade B in a 3rd subject | B with no component below B                                 | AAB         |
| Microbiology BSc (Hons)   | FB           | AA in two sciences (preferably Biology and Chemistry), grade B in a 3rd subject            | B with no component below B                                 | AAB         |
| Molecular Biology BSc (Hons)                                      | FB           | AA in Chemistry and another science subject (preferably Biology), grade B in a 3rd subject | B with no component below B                                 | AAB         |
| Neuroscience BSc (Hons)*  | FB           | AA in two sciences (preferably Biology and Chemistry), grade B in a 3rd subject            | B with no component below B                                 | AAB         |
| Optometry BSc (Hons)  | FB           | Chemistry, Biology and Maths. Students are required to attend an interview                 | B   | AAB         |
| Pharmacology BSc (Hons)*  | FB           | AA in two sciences (preferably Biology and Chemistry), grade B in a 3rd subject            | B with no component below B                                 | AAB         |
| Pharmacy MPharm (Hons)  | FPH          | Chemistry, Biology and Maths. Students are required to attend an interview                 | B   | AAB         |
| Physics BSc (Hons)*   | FPN          | A*A* in Physics and Maths  | C   | A*A*A       |
| Physics with Astrophysics BSc (Hons)*                             | FPN          | A*A* in Physics and Maths  | C   | A*A*A       |
| Planning and Real Estate BSc (Hons)                               | FES or FHSS  | None   | B   | ABB         |
| Politics and International Relations BSocSc (Hons)                | FHSS         | None   | B with B in Writing and Listening and no component below C  | AAA         |
| Politics, Philosophy and Economics BA (Hons)                      | FHSS         | None   | B with B in Writing and Speaking and no component below C   | AAA         |
| Psychology BSc (Hons)   | FPS          | Chemistry, Biology and Maths   | B   | AAB         |
| Social Anthropology BSocSc (Hons)                                 | FHSS         | None   | B with B in Writing and Speaking and no component below C   | ABB         |
| Sociology BSocSc (Hons)   | FHSS         | None   | B with B in Writing and Speaking and no component below C   | ABB         |

Degree option with a year in industry also available.  
 Degree option with a year abroad or with overseas experience also available.

Please note: English level and academic progression requirements are correct to the best of our knowledge at the time of going to print. In some circumstances these may change throughout the year - please visit [www.intostudy.com/manchester/courses](http://www.intostudy.com/manchester/courses) for the most up to date information. Progression requirements, including English level and final grade, may be higher for degrees with a year in industry, year abroad/overseas placement, and with an integrated Master's.

\* Also available as an integrated Master's  
\*\* Offered as a progression option for Sept 2022 not Jan 2023

Find comprehensive information on all academic pathway programmes, degree options and progression requirements at: [www.intostudy.com/manchester/courses](http://www.intostudy.com/manchester/courses)



# English courses

Study English at INTO Manchester to improve your English level fast with tailored, personalised support and for the smoothest transition to further UK academic studies.

## EN Academic English

This course is for you if:

- > You want to study an English course that is more than language learning – you'll develop the academic skills needed to successfully study in the UK.
- > You want to benefit from studying in an English-speaking environment where you can easily practice your language skills and immerse yourself in the culture.

How will Academic English benefit me?

- Focus on reading, writing, speaking and listening in a context that reflects the skills you must have in order to succeed at university.
- Gain the academic language skills you need to succeed in further UK education.
- Prepare to pass any English language assessments you may need to take, such as IELTS.
- You'll have regular one-to-one tutorials with your teachers where you'll receive detailed feedback and help with your individual study plan.
- Take advantage of a diverse social programme, effective academic content and unique language learning opportunities in the city, which will help you to develop the fluency and confidence you need to progress to further study.
- You'll be taught by highly experienced English teachers who have worked in many different countries and have a wide range of expertise, including course development, materials writing and assessment management.
- Extended International Foundation courses available with a term of Academic English in one programme.



"I enjoy teaching on the Academic English programme because I feel I can make a real difference to our students in developing the language and study skills they need when they get to university, in a relatively short amount of time. Seeing how much progress they can make in just ten intensive weeks is really rewarding."

Kes Poupaert  
Academic English teacher, INTO Manchester

"Studying Academic English was quite different to studying IELTS. For me, the most important skill I gained was how to write in a more academic style. Our teachers placed a lot of emphasis on this skill as it's essential for successful university study. Studying Academic English helped me adapt to the style of teaching and learning at UK universities. Now I feel I will achieve better grades."

Suxuan, China  
Academic English, INTO Manchester

Improve your English language skills to prepare for further academic study

### Start date

16 weeks: Aug  
1-4 terms: Sep, Jan, Apr, Jun

### English language entry requirements

From IELTS 3.0 or equivalent

### Age requirement

16 years and above

### Class size and hours

Maximum of 16 students

30 learning hours per week, with 25 hours of face-to-face contact

**Note:** 1 term = 11 weeks (10 of which are teaching weeks)

Accredited by the



for the teaching of English in the UK

All our English language courses at INTO Manchester have received accreditation from the British Council.

# SUCCESSFUL INTO ALUMNI



"I'm thankful for INTO because it helped me understand my environment here in Manchester. A lot of people come to University and the UK for the first time, and struggle to handle it but I feel like having time at INTO to get used to everything was extremely helpful."

Sonya, Malaysia  
LLB (Hons) Law,  
The University of Manchester



"At INTO, you have a lot of support and if you have any issues your Personal Tutor is there to help. They recognise areas where you are doing well and give you challenges to continue your personal development. Living abroad can be daunting, so the support that INTO gives us is very beneficial."

Ilya, Kazakhstan  
Engineer  
BEng (Hons) Petroleum Engineering,  
The University of Manchester

"For the application to Architecture, we had to submit a portfolio and were provided with a 10-day course in Art at The University of Manchester. The teacher showed us how to set up our portfolio and the different kinds of sketches we'll be producing on the course!"

Camila, Ecuador  
BA (Hons) Architecture,  
The University of Manchester



# Dates and prices

The cost of your programme may vary depending on factors including the pathway chosen and programme length. The following guide to costs is based on pricing for the current academic year and provides an indication of the cost of attendance for some of our pathways. For specific cost information, please refer online: [www.intostudy.com/manchester/courses](http://www.intostudy.com/manchester/courses)

| Estimated cost of attendance based on prices for current academic year 2021-2022 |         |                |                |                 |           |                        |
|--|---------|----------------|----------------|-----------------|-----------|------------------------|
| Study length   | Tuition | Accommodation  | Books and fees | Airport pick up | Insurance | Total                  |
| <b>Academic programmes</b>   |         |                |                |                 |           |                        |
| <b>International Foundation (3 term)</b>   | £19,565 | £6,000-£12,000 | £435-£835      | £45             | £357      | <b>£26,357-£32,757</b> |
| <b>International Foundation (4 term)</b>   | £24,595 | £8,160-£15,300 | £530-£930      | £45             | £466      | <b>£33,751-£41,291</b> |
| <b>English language courses</b>  |         |                |                |                 |           |                        |
| <b>1 term*</b>   | £4,430  | £1,760-£3,300  | £95            | £45             | £122      | <b>£6,407-£7,947</b>   |
| <b>16 weeks</b>  | £7,090  | £2,560-£4,800  | £135           | £45             | £145      | <b>£9,930-£12,170</b>  |

| Start months and term dates |                                 |                           |                                 |
|-----------------------------|---------------------------------|---------------------------|---------------------------------|
| Academic programmes         |                                 | Academic English          |                                 |
| <b>June (4 term)</b>        | Mon 27 Jun 2022-Fri 16 Jun 2023 | <b>August (16 weeks)</b>  | Mon 08 Aug 2022-Fri 09 Dec 2022 |
| <b>September (3 term)</b>   | Mon 12 Sep 2022-Fri 16 Jun 2023 | <b>September (1 term)</b> | Mon 26 Sep 2022-Fri 09 Dec 2022 |
| <b>September (4 term)</b>   | Mon 26 Sep 2022-Fri 25 Aug 2023 | <b>January (1 term)</b>   | Mon 09 Jan 2023-Fri 24 Mar 2023 |
| <b>January (3 term)</b>     | Mon 09 Jan 2023-Fri 25 Aug 2023 | <b>April (1 term)</b>     | Mon 03 Apr 2023-Fri 16 Jun 2023 |
|                             |                                 | <b>June (1 term)</b>      | Mon 26 Jun 2023-Fri 08 Sep 2023 |

Please note the dates and prices shown are for the current academic year of 01 September 2021 - 31 August 2022 and are for indicative purposes only. All students who confirm their offer on or before 31 January 2022 will pay the 2021/2022 price as per their existing offer letter. After 31 January 2022, where tuition fees have increased or dates changed, students will receive a new offer letter detailing the new 2022/2023 pricing and dates. For full details of term dates, please visit the relevant course page at [www.intostudy.com/manchester/courses](http://www.intostudy.com/manchester/courses)

\* The price will depend on your start date and length of study. Prices shown are only for one term.  
Vacation weeks in between terms are extra and will be charged at the weekly accommodation price.



**Apply via your local INTO educational counsellor**

If you would like us to put you in contact with one of our counsellors, please contact us.



**Apply online**

Complete our online application form: [apply.intostudy.com](http://apply.intostudy.com)



**Need some help with your tuition fees?**

Check to see if you're eligible for a scholarship: [www.intostudy.com/manchester/scholarships](http://www.intostudy.com/manchester/scholarships)

## Discover more online

For students:  
[www.intostudy.com/manchester](http://www.intostudy.com/manchester)  
For education counsellors:  
[partnerportal.intoglobal.com/manchester](http://partnerportal.intoglobal.com/manchester)

## Connect with us



Through innovative partnerships with leading universities, we expand opportunities for higher education, ensuring success and transforming the lives of our students and staff.

## INTO GIVING

Working across the globe, INTO Giving supports projects that increase access to education and improve the quality of teaching and learning. For more information visit [www.into-giving.com](http://www.into-giving.com)

## Contact us

Enquiries and applications:  
[ukes@intoglobal.com](mailto:ukes@intoglobal.com)  
or +44 1273 876040  
Visit the Centre:  
[marketing.manchester@intoglobal.com](mailto:marketing.manchester@intoglobal.com)  
or +44 161 631 1200

Centre address details:  
INTO Manchester  
Bridgewater House  
58/60 Whitworth Street  
Manchester  
M1 6LT  
United Kingdom

© INTO Manchester Limited, September 2021. Every effort is made to ensure that content published in this document is correct at the time of publication. However, from time to time there may be occasions where some of the information has changed since the date of publication. The most up to date information can be found on our website at [www.intostudy.com/manchester](http://www.intostudy.com/manchester) - please refer to this before submitting your application. If, in our opinion, we consider that any change has been made which has a material impact on any offer that has been made to you to study with us, we will inform you of these changes in writing. The information provided in this document is subject to INTO Manchester in partnership with The University of Manchester's terms and conditions which can be accessed at [www.intostudy.com/manchester/terms](http://www.intostudy.com/manchester/terms).

INTO Manchester Limited, 6438137, One Gloucester Place, Brighton, East Sussex, BN1 4AA, UK.

Education provider sponsor number 6FY6FQBVI

Education counsellor's stamp



The University of Manchester