



FROM THE  
**NATION'S CAPITAL**



TO THE  
**GLOBAL  
STAGE**

MASON MAKES IT HAPPEN





# WHY CHOOSE GEORGE MASON UNIVERSITY?

## FAST FACTS

Founded in **1972**

Campus: **Fairfax, Virginia**

County Population: **1M+**

Campus Size: **677 acres**

Enrollment: **38,000+**

International Students: **4,450+**

Countries Represented: **130+**

Bachelor's: **80+**

Master's and PhD: **125+**

Research: **\$186M**

Additional Campuses:  
**Arlington, Virginia; Science and  
Technology Campus in Prince  
William County, Virginia; Mason  
Korea in Incheon, South Korea**

Study near **Washington, DC**,  
the nation's capital.



### Virtual Campus Tour

Take a campus tour from home  
with Mason's Virtual Tour at  
[www.youvisit.com/gmu](http://www.youvisit.com/gmu)

## #65

Top Public Schools

*U.S. News & World Report 2021*



Tier 1 Research Institute

*Carnegie Classification of Institutions  
of Higher Education*

## Top 20

for Ethnic Diversity amongst  
National Universities

*U.S. News & World Report 2021*

## #35

Most Innovative School

*U.S. News & World Report 2021*

## 16:1

Student-to-Faculty Ratio



## #143

National Universities

*U.S. News & World Report 2021*



## LOCATED FOR OPPORTUNITY

- Washington, DC is one of the top 10 cities in the United States to find a job.  
*Indeed 2019*
- Mason ranked No. 1 U.S. young university  
*Times Higher Education 2021*
- Northern Virginia is home to Amazon's second headquarters.
- Washington, DC is the No. 12 Best Metro Area for STEM Professional Opportunities.  
*WalletHub 2021*



Mason's main **Fairfax Campus** is  
24 km from Washington, DC.



The **Arlington Campus (Graduate  
programs only)** is 8 km from  
Washington, DC.

**177 foreign embassies located in  
Washington, DC**





# ABOUT GEORGE MASON UNIVERSITY

A Mason education prepares you for a meaningful career in a global society. You will learn from successful individuals who have put their stamp on the world. They will inspire you to do the same. Studying in the nation’s capital also has its benefits. You will sit in class with policymakers, just minutes away from government branches making today’s biggest decisions. Washington, DC-based media, politics, business and technology pave the way for new approaches and products.

“ International students contribute greatly to the cultural and intellectual fabric of George Mason University, benefiting everyone in our community. Our best-in-state diversity ranking is in no small part dependent on the students from more than 130 countries who choose Mason for its academic and inclusive excellence. We are proud to say that you can meet the world on our campus. ”

**Gregory Washington, PhD**  
President, George Mason University

## The INTO Mason Advantage

George Mason University partners with INTO to create a support system for international students. We offer Academic English, International Year One, Undergraduate Transfer Program, Graduate Pathway and Bridge programs where you work alongside your American peers and earn credit toward your degree while improving your English skills. After successful completion of your program you will be able to progress to a Mason degree program.

INTO Mason is located on campus and provides students with many services including:

- Visa and immigration support
- Free airport pickup
- Orientation
- Cultural programming and social activities
- Free tutoring and language support
- Academic advising
- Housing assistance



**\$186M**  
spent on research  
in 2019

### Redefining Excellence

At Mason, we believe in applying what you learn in the classroom to real-world problems. Undergraduate and graduate students have access to hands-on learning opportunities outside the classroom and are involved in research that impacts the world.

### Labs and research centers include:

- Mason Innovation Exchange (MIX): on-campus collaboration space featuring 3D printers, virtual reality and robotics
- Virginia Serious Game Institute: only serious game institute in the United States focusing on applied research and new game cultivation
- Innovation Lab: pairs students across all degree programs at Mason with mentors to develop new business ideas
- Mercatus Center: research center dedicated to bridging the gap between academic research and public policy problems
- Program-Specific Labs: robotics, simulation, biomechanics and forensic crime scene



## INTO Mason Student Success

**97% of all completed Pathway students were eligible to progress at Mason in 2019-20.** Eligible students are those who successfully completed the Pathway program and qualified for admission as degree-seeking students. Enrolled students are those who enrolled as degree-seeking students in their next term of degree study at George Mason University.

### Undergraduate and Graduate Pathway Progression Rate 2019-2020

**97%**  
**PASSED**

**96%**  
**ENROLLED**

# LIVING NEAR WASHINGTON, DC

Washington, DC offers endless cultural and social opportunities year-round.

- Visit famous attractions including the US Capitol building, the White House and free Smithsonian museums.
- Taste authentic cuisines from one of DC’s 2,200+ restaurants.
- Cheer on a DC sports team at a baseball, basketball or hockey game.
- Watch a performance at the world-famous Kennedy Center.
- Attend one of DC’s many multicultural festivals.



## The Fairfax Campus



## The Mason Korea Campus



## The Arlington Campus



### The Fairfax Campus

Fairfax is a safe, residential area in the heart of Northern Virginia. Find diverse restaurants, shops and theaters within walking distance of campus. Students can take free shuttles around Fairfax and to the Metro station to go directly into Washington, DC.

### The Mason Korea Campus

The Mason Korea campus offers US degrees in six undergraduate disciplines in order to educate the next generation of global leaders. Approved by the Korean Ministry of Education, these degree programs allow students to spend three years at Mason Korea in Songdo and one year in the US at our campus in Fairfax, Virginia. When these students graduate, they will receive the same degree as all students from George Mason University.

Undergraduate Programs

- **Business (all concentrations)**
- **Economics**
- **Global Affairs**
- **Computational and Data Sciences**
- **Computer Game Design**
- **Conflict Analysis & Resolution**

Find out more about Mason Korea at [masonkorea.gmu.edu](https://masonkorea.gmu.edu)

### The Arlington Campus

This campus, located in the safe and urban Arlington neighborhood of Virginia Square, has a strong focus on career development and hosts a variety of Mason’s graduate and professional programs. Just 15 minutes outside of Washington, DC, the Arlington Campus is located a short distance away from Amazon’s future second headquarters.

### Programs Offered

You will have classes at this campus if you are in one of the following Graduate Pathway programs:

- **Accounting\***
- **Arts Management**
- **Business Administration (MBA)**
- **Conflict Analysis and Resolution**
- **Economics**
- **International Commerce and Policy**
- **Management (Business)**
- **Public Policy**
- **Real Estate Development**

\* The Accounting Pathway courses are held in Fairfax, but the accounting degree program is based in Arlington. Find out more about our Arlington Campus at [arlington.gmu.edu](https://arlington.gmu.edu)





# HOUSING AND DINING

Feel right at home at Mason. We have everything you need to settle into university life whether you need a place to live, study, eat or hang out with friends.

## GLOBAL CENTER - DOUBLE ROOM

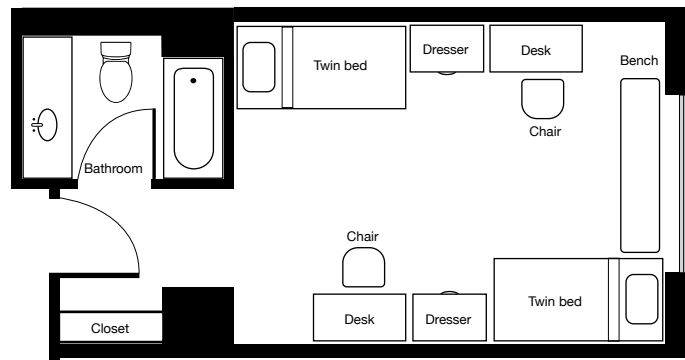

## SANDBRIDGE HALL - DOUBLE ROOM

\*Students may also be placed in Whitetop Hall, which has a similar floorplan.



- Ángel Cabrera Global Center houses 270 students. Living here, you will be connected with cultures from all over the world. You will have access to free laundry facilities, 22 classrooms, a meditation space, and a buffet-style dining hall. All residence halls are double-occupancy with a full en-suite bathroom.
- Eastern Shore Residence Hall houses upper-class honors students, the College of Engineering and Computing Living Learning Community, and INTO Mason students.
- Sandbridge Hall is located in the center of campus and houses 300 residents. With six floors offering three-, four-, or five-person suites, you have plenty of options to choose from.
- Southside Dining Hall is conveniently placed for you to grab a bite to eat in between classes. This all-you-care-to-eat venue provides eight different stations with eight different cuisine options.
- The Globe is an all-you-care-to-eat residential dining hall offering halal, vegetarian and gluten-free options and is open 365 days a year.

\*You must be 17 years old to live on-campus. For more information on housing, please contact [intofd@gmu.edu](mailto:intofd@gmu.edu).

## Become a Part of Mason Nation

- Join one of the 460+ student organizations.
- Attend a free game for one of the 20 NCAA Division I athletic teams.
- Take part in International Week competitions and events.
- Participate in holiday parties and fairs in your residence hall.
- Get your friends together and create a club sports team.
- Make a difference by volunteering for great causes.
- Attend a concert at EagleBank Arena.

For more information about living at Mason, visit [www.intostudy.com/mason/living](http://www.intostudy.com/mason/living)



“

The goal of international affairs is to contribute to society and to improve lives all over the world. At George Mason, you are encouraged to analyze these global issues and think critically. It's one of the most valuable skills that you can learn for the working world.

”

**Kevin, China**  
Master's in International Commerce and Policy

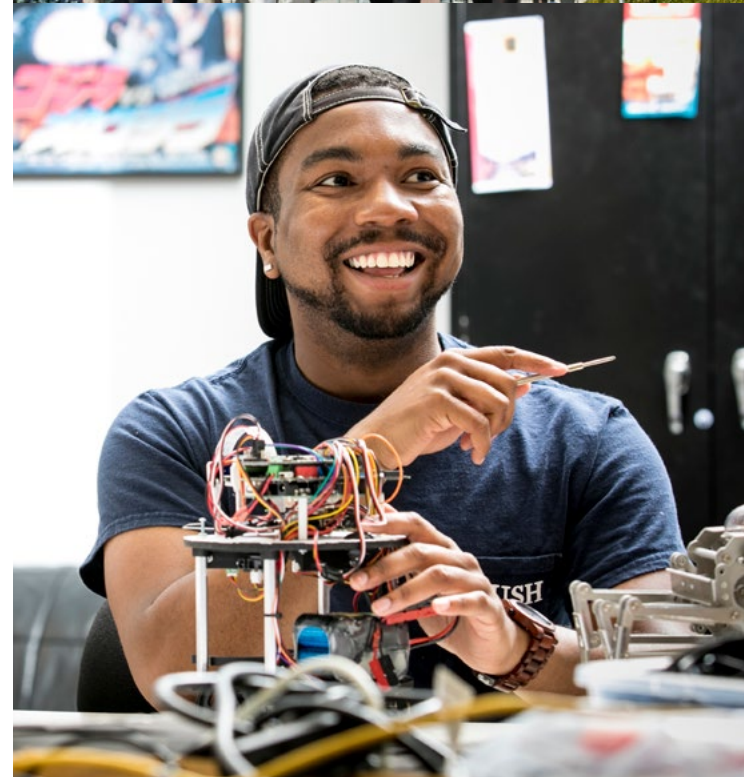

## ACADEMIC STRENGTHS

As a top 100 public university, Mason's programs prepare you to lead the way in innovative research, new technologies, global policy and cybersecurity.

### International Relations, Economics and Business

With Washington, DC as your backyard, there is no better place to prepare for a global career. Mason's top-ranked programs from the Schar School of Policy and Government, School for Conflict Analysis and College of Business prepare you to engage and communicate across cultures. Students gain access to world-renowned organizations and engage in issues by studying foreign affairs, diplomacy, international development and business.

### Engineering and Cybersecurity

Mason's engineering program was built to directly assist with official national security priorities, and holds one of the longest track records of advancing information security in the United States. Mason was also ranked No. 93 in Best Engineering Graduate Schools by *U.S. News & World Report 2022*.

**#6**

Conflict Analysis and Resolution Program  
*Universities.com 2021*

**#10**

Criminology Graduate  
*U.S. News & World Report 2021*

**#19**

Cybersecurity Undergraduate  
*U.S. News & World Report 2021*

**#60**

Best Public Health Graduate Schools  
*U.S. News & World Report 2021*

**#23**

Public Policy Analysis Graduate  
*U.S. News & World Report 2021*

**#33**

Healthcare Management Graduate  
*U.S. News & World Report 2019*

**#37**

Systems Engineering Graduate  
*U.S. News & World Report 2021*

**#76**

Computer Engineering Graduate  
*U.S. News & World Report 2021*

**#81**

Best Undergraduate Business Programs  
*U.S. News & World Report 2021*





## WORLD-CLASS FACULTY AND ALUMNI

At Mason, you will learn from professors who are top scholars in their fields and global policymakers for today's largest issues. Discover how Mason's expert faculty will transform your academic journey into meaningful career development.

### Learn from Policy Leaders

Mason's faculty are not just in your classroom, they are taking part in global discussions at the White House, the United Nations, United States Congress and more. It is common to see your professors penning articles in prevalent publications that circulate around the world, like *The New York Times*, *The New Yorker* and *The Washington Post*.



**Dr. Amira Roess** is a professor of Global Health and Epidemiology in the College of Health and Human Services, where she leads research on the emergence and transmission of infectious diseases from animals to humans. Her current studies in the US, Bangladesh, Egypt, and Ethiopia are funded by the Gates Foundation and the National Science Foundation.



**Michael V. Hayden** is a former CIA and NSA director who teaches in the Schar School of Policy and Government. He also founded the Michael V. Hayden Center for Intelligence, Policy and International Security at Mason.

### Mason's Alumni Change the World

We are not kidding, Mason's alumni are out of this world. They go to space. They win Pulitzer Prizes. They work in the White House. They create life-changing laws. With a Mason degree, you can do anything.



**Anousheh Ansari** got her bachelor's in electrical engineering from Mason. She was the first Iranian-American and Muslim woman in space.



**Hala Gorani** got her bachelor's in economics from Mason and is an award-winning CNN anchor. She is the senior correspondent for CNN International, based in London.



"Looking back, I could not even imagine that I would find a spot in this highly competitive career market. However, the skills I gathered throughout my path at George Mason University helped me not only be competitive but also become one of the rising stars. Right after my graduation, I was offered a full-time job at Mason Dining Services as a Marketing Coordinator. Today, I am the head of the Marketing Department. INTO Mason is a springboard that helps you jump into the American dream."

**Sofya**, Russia  
BS, Tourism and Events Management  
Marketing Director at Mason Dining - Sodexo

## FOCUSED ON YOUR FUTURE

### Mason University Career Services offers support to students through:

- Résumé and interview workshops
- On-campus career fairs with 300+ employers from top companies in the area
- Access to a strong professional network in various industries
- Curricular Practical Training (CPT) and Optional Practical Training (OPT) workshops



### TOP EMPLOYERS OF MASON ALUMNI

- Accenture
- Apple
- Deloitte
- General Dynamics
- Inova Health System
- Marriott International
- NASA
- Northrop Grumman
- Smithsonian Institution
- U.S. Department of Homeland Security
- U.S. Department of Justice
- U.S. Department of State



### Experiential Learning

74% of graduating students participated in experiential learning, which includes internships, research, study abroad, student leadership and work related to career goals.



### Did you know?

- **84% of Mason graduates** reported a positive career outcome within six months of graduation
- **87% of employed students** are in positions related to their career goals
- **\$65,500 average first-year salary** earned by Mason graduates

### THE ARRIVAL OF AMAZON'S WORLD HQ 2

Northern Virginia, where Mason's Arlington and Fairfax campuses are located, is home to Amazon's second headquarters. Amazon expects to create more than 25,000 job opportunities for highly skilled graduates.

Mason will create a pipeline for talent and innovation that serves the region by investing \$250 million to expand the Arlington Campus over the next five years, including:

- A new School of Computing on the Arlington Campus
- Institute for Digital Innovation (IDIA), a hub of innovation bringing together entrepreneurs, researchers and business leaders
- Increasing enrollment from 6,500 students in computing programs to 13,000 by 2024





# ACADEMIC PROGRAMS

**FIND YOUR DEGREE.** With a wide range of subject areas and admissions options, you can find the perfect degree for your chosen career. You can choose to apply for direct entry to the university or for a Pathway program that provides extra academic, language and cultural support. From the day you apply to the day you graduate, we are here to help you succeed every step of the way. Turn to the back cover to learn how to apply.

B = Bachelor's	M = Master's	D = Doctorate
<b>GP</b> Graduate Pathway program that can lead to this degree is indicated in purple. This degree is also available through direct admission.		
● Indicates a George Mason University degree program.		
★ Indicates a three-year international undergraduate degree can lead to this master's degree through the Graduate Bridge Program.		
▶ Designated STEM degree by the U.S. Department of Homeland Security.		

## International Year One

Indicates the Undergraduate Pathway program that should be taken to progress to an undergraduate academic program. This program is also available through direct admission.

<b>BU</b>	<b>Business</b>	<b>HD</b>	<b>Human and Social Development</b>
<b>EC</b>	<b>Engineering, Computing and Statistics</b>	<b>HS</b>	<b>Humanities and Social Sciences</b>
		<b>SC</b>	<b>Science</b>

	B	M	D
<b>Antonin Scalia Law School</b>			
Law (LLM: Global Antitrust Law and Economics; Intellectual Property; Law and Economics; US Law)		●	●
Law and Public Policy		●	●
<b>College of Education and Human Development</b>			
<b>Graduate School of Education</b>			
Counseling [MEd concentrations: Clinical Mental Health Counseling; School Counseling]		●	
<b>Curriculum and Instruction*</b> [MEd concentrations: Advanced Studies in Teaching and Learning; Assistive Technology; Teaching Culturally & Linguistically Diverse & Exceptional Learners; <b>Early Childhood and Elementary Education</b> ; Learning Technologies; Literacy/Reading; Mathematics Specialist Leader; Secondary Education (6-12); Transformative Teaching]		GP	
Early Childhood Education for Diverse Learners	●		
Education [PhD concentration: Kinesiology]			●
Education Leadership [MEd concentrations: International School Leadership Research; Independent School Leadership]		●	
<b>Educational Psychology*</b> [MS concentrations: <b>Assessment, Evaluation and Testing</b> ; Learning and Decision-Making in Leadership; <b>Learning, Cognition and Motivation</b> ; Teacher Preparation]		GP	
Elementary Education; PK- 6 Licensure	●		
▶ Learning Design and Technology		●	
Psychology [MA concentration: School Psychology]		●	
<b>Special Education*</b> [BS concentrations: General K-12 Licensure; Adapted K-12 Licensure; Blindness and Visual Impairments PK-12 Licensure; No Concentration] [MEd concentrations: <b>Early Childhood Special Education; No Concentration</b> ]	●	GP	
<b>School of Recreation, Health and Tourism</b>			
Athletic Training		●	
Human Development and Family Science	●		
Kinesiology	HD	●	
Physical Education	●		
Recreation Management [BS concentrations: Parks and Outdoor Recreation; Therapeutic Recreation]	●		
<b>Sport and Recreation Studies*</b> [MS concentrations: Individualized Study in Sport; Recreation and Tourism; <b>Recreation Administration; Sport and Leisure Studies; Sport Management</b> ]		GP	
Sport Management	●		
Tourism and Events Management	HD		
<b>College of Health and Human Services</b>			
Community Health [BS concentrations: Global Health; Clinical Science; Nutrition; Physical Activity and Public Health]	HD		
Global Health		●	
Health Administration [BS concentrations: Assisted Living/Senior Housing Administration; Health Informatics; Health Systems Management]	HD		
Health and Medical Policy		●	
▶ <b>Health Informatics</b> [MS concentrations: <b>Health Data Analytics; Health Informatics Management; Population Health Informatics</b> ]	●	GP	
Health Services Research [PhD concentrations: Health Systems and Policy; Knowledge Discovery and Health Informatics]			●
<b>Health Systems Management</b>		GP	
Nursing [MSN concentrations: Adult Gerontology Nurse Practitioner; Advanced Clinical Nursing; Family Nurse Practitioner in Primary Care; Nursing Administration; Nurse Educator] [DNP concentrations: Psychiatric Mental Health Nurse Practitioner; Adult Gerontology Nurse Practitioner; Family Nurse Practitioner; Nursing Administration] [PhD concentration: Individualized Study in Nursing]	●	●	●
<b>Nutrition</b>		GP	
<b>Public Health</b> [MPH concentrations: <b>Community Health Promotion; Epidemiology; Food Security and Nutrition; Global Health; Health Policy; Public Health Communication; Public Health Practice</b> ] [PhD concentration: Epidemiology; Social and Behavioral Sciences]		GP	●
<b>Social Work</b> [MSW specializations: <b>Children, Youth, and Families; Adults and Healthy Aging</b> ]	HD	GP	
<b>College of Humanities and Social Sciences</b>			
Anthropology	HS	●	
Applied Industrial and Organizational Psychology		●	
Art History	HS	●	

	B	M	D
<b>Communication</b> [BA concentrations: Interpersonal and Organizational Communication; Journalism; Media Production and Criticism; Political Communication; Public Relations] [MA specializations : <b>Science Communication; Strategic Communication/Public Relations; Health Communication; Individualized</b> ]	HS	GP	●
Creative Writing [BFA concentrations: Fiction; Nonfiction; Poetry] [MFA concentrations: Fiction; Nonfiction Writing; Poetry]		●	
Criminal Justice		●	
Criminology, Law and Society [BA/BS concentrations: Criminal Justice; Law and Society; Homeland Security and Justice]	HS	●	●
Cultural Studies			●
<b>Economics</b> [BA concentrations: Philosophy; Politics and Economics] [BS concentrations: Managerial Economics; Philosophy; Politics and Economics]	HS	GP	●
<b>English</b> [BA concentrations: Creative Writing; Cultural Studies; Film and Media Studies; Folklore and Mythology; Literature; Linguistics; Writing and Rhetoric] [MA concentrations: Cultural Studies; Folklore Studies; <b>Linguistics</b> ; Literature; Professional and Technical Writing; Teaching of Writing and Literature]	HS	GP	
Foreign Languages [BA concentrations: Arabic; Chinese; French; Korean; Spanish] [MA concentrations: French; Spanish; Spanish and French; Spanish/ Bilingual-Multicultural Education]	HS	●	
<b>Global Affairs*</b> [BA concentrations: The Environment; Global Economy and Management; Global Governance; Global Inequalities and Responses; Human Security; International Development; Media, Communication and Culture; By World Region (Africa, Asia, Europe, Latin America, Middle East and North Africa, North America, Russia and Central Asia); Individualized] [MA specializations: <b>Global Conflict and Security; Global Culture and Society; Global Economics and Development; Global Education; Global Governance and Public Management; Global Health; Global Media and Information Technology; Global Population and Geography</b> ]	HS	GP	
Higher Education and Student Development			●
History [BA concentrations: Digital History; Public History; Global History; Individualized; U.S. History] [MA concentrations: Predoctoral History; Applied History; Applied History with New Media and Information Technology Emphasis; Enrichment; Higher Education;Teaching]	HS	●	●
Individualized Study [BIS concentrations: Individualized, Early Childhood Education Studies]	●		
Interdisciplinary Studies [MAIS concentrations: Computational Social Science; Energy and Sustainability; Religious Studies; Social Entrepreneurship; Social Justice and Human Rights; War and Military in Society; Women and Gender Studies; Individualized]		●	
Linguistics (See also English)			●
Middle East and Islamic Studies		●	
Philosophy [BA concentrations: Philosophy and Law; Philosophy; Politics and Economics] [MA concentrations: Ethics and Public Affairs; Philosophy and Cultural Theory]	HS	●	
Psychology [BA/BS concentrations: Clinical Psychology; Developmental Psychology; Educational Psychology; Health Psychology; Cognitive and Behavioral Neuroscience] [MA concentrations: Applied Developmental Psychology; Clinical Psychology; Cognitive and Behavioral Neuroscience; Industrial and Organizational Psychology; Human Factors/Applied Cognition] [PhD concentrations: Applied Developmental Psychology; Cognitive and Behavioral Neuroscience; Clinical Psychology; Human Factors/ Applied Cognition; Industrial and Organizational Psychology]	HS	●	●
Religious Studies	HS		
Russian and Eurasian Studies [BA concentrations: Eurasian Studies; Russian Studies; Russian Language and Culture]	HS		
Sociology [BA concentrations: Childhood and Youth; Deviance; Crime and Social Control; Global Sociology; Inequality and Social Change] [PhD concentrations: Institutions and Inequalities, Sociology of Globalization]	HS	●	●
Writing and Rhetoric (See also English)			●

## School of Integrative Studies

▶ Environmental and Sustainability Studies [BA concentrations: Business and Sustainability; Climate Change and Society; Conservation and Sustainability; Environmental Policy and Economics; Equity and Environmental Justice; Sustainable Food and Agriculture]	HS SC		
Integrative Studies [BA concentrations: Childhood Studies; International Studies; Leadership and Organizational Development; Legal Studies; Education Studies; Social Innovation; Social Justice and Human Rights; Social Science for Education; Women and Gender Studies; Individualized] [BS concentrations: Applied Global Conservation; Life Sciences; Individualized]	HS		

<b>College of Science</b>			
▶ <b>Applied and Engineering Physics</b> [Concentrations: <b>Standard Physics; Applied Physics; Engineering Physics; Quantum Information Science and Engineering</b> ]			GP
▶ Astronomy	SC		
▶ Atmospheric Sciences	●		
▶ <b>Bioinformatics and Computational Biology</b>		GP	●

	B	M	D
▶ <b>Bioinformatics Management</b>		GP	
▶ Biology [BA concentration: Biological Illustration] [BS concentrations: Biotechnology and Molecular Biology; Environmental and Conservation Biology; Bioinformatics; Biopsychology; Microbiology] [MS concentrations: Evolutionary Biology; Microbiology and Infectious Disease; Molecular Biology; Neuroscience; Nutrition Genetics and Nutraceuticals; Translational and Clinical Research]	SC	●	
▶ Biosciences [PhD concentrations: Biocomplexity and Evolutionary Biology; Cell and Molecular Biology; Microbiology and Infectious Diseases]		●	
▶ Chemistry [BA concentration: Biochemistry] [BS concentrations: Analytical Chemistry; Environmental Chemistry; Biochemistry; Materials Chemistry] [MS concentration: Biochemistry]	SC	●	
▶ Chemistry and Biochemistry			●
▶ Climate Dynamics			●
▶ Climate Science [MS concentrations: Climate Modeling; Climate Data]		●	
▶ Computational and Data Sciences	SC		
▶ <b>Computational Science</b>		GP	
▶ Computational Sciences and Informatics			●
Computational Social Science			●
▶ <b>Earth Systems Science</b>		GP	
▶ Earth Systems and Geoinformation Sciences			●
▶ Environmental Science [BS concentrations: Conservation; Ecological Science; Environmental Health; Human and Ecosystem Response to Climate Change; Marine; Estuarine and Freshwater Ecology; Wildlife]	SC		
▶ <b>Environmental Science and Policy</b> [MS concentrations: <b>Aquatic Ecology; Conservation Science and Policy; Environmental Science and Policy; Communication for Environmental Science; Policy and Human Behavior; Environment and Management; Energy and Sustainability Policy and Science; Conservation Medicine and Planetary Health</b> ]		GP	
▶ Environmental Science and Public Policy			●
▶ <b>Forensic Science</b> [BS concentrations: Forensic Biology; Forensic Chemistry] [MS concentrations: <b>Crime Scene Investigation; Forensic Biology Analysis; Forensic Chemistry Analysis; Forensic/Biometric Identity Analysis</b> ]	SC	GP	
Geography [BA concentrations: Environmental Geography; Health Geography; Geanthropology]	SC		
<b>Geographic and Cartographic Sciences</b>		GP	
▶ Geoinformatics and Geospatial Intelligence		●	
▶ Geology [BS concentrations: Earth Surface Processes; Environmental Geoscience; Geology; Oceanography and Estuarine Science; Paleontology]	SC		
▶ <b>Mathematics</b> [BS concentrations: Actuarial Mathematics; Applied Mathematics; Mathematical Statistics]	SC	GP	●
▶ Medical Laboratory Science [BS concentrations: Generalist; Molecular Biology; Microbiology; Histotechnology]	SC		
▶ Neuroscience	SC		●
▶ Physics [BS concentrations: Applied and Engineering Physics; Astrophysics; Computational Physics] [PhD concentrations: Standard; Engineering Physics]	SC		●

<b>College of Visual and Performing Arts</b>			
Art and Visual Technology [BA concentrations: Drawing; Graphic Design; New Media Art; Painting; Photography; Printmaking and Book Arts; Sculpture] [BFA concentrations: Drawing; Graphic Design; InterArts; New Media Art; Painting; Photography; Printmaking and Book Arts; Sculpture]	●		
Art Education [MAT concentration: Licensed Art Teachers]		●	
<b>Arts Management</b>		GP	
▶ Computer Game Design	●		
Dance	●		
Film and Video Studies [BA concentrations: Producing; Directing; Screenwriting; Production and Post Production]	●		
<b>Music</b> [BA concentrations: Pedagogy; Music Technology] [BM concentrations: Composition; Jazz; Music Education; Music Technology; Performance] [MM concentrations: Collaborative Piano; Composition; Conducting; <b>Jazz Studies</b> ; Music Education; Pedagogy; <b>Performance</b> ]	HS	GP	
Musical Arts [DMA concentrations: Conducting, Composition, Performance]			●
Music Education			●
Theater [BA concentrations: Design and Technical Theater; Performance; Theater Education for Theater Arts PK-12; Theater Studies] [BFA concentrations: Design for Stage and Screen; Musical Theater Performance; Performance for Stage and Screen (Acting and Directing)]	●		
Visual and Performing Arts [MFA concentrations: Dance; Graphic Design; Theater; Visual Arts]		●	

<b>School of Business</b>			
<b>Accounting*</b>		GP	
<b>Business Administration*</b> [Emphases: <b>Accounting; Business Analytics; Entrepreneurship; Financial Management; International Business; Leadership; Marketing; Project Management; Government Contracting</b> ]		GP	
Business [BS concentrations: Accounting; Business Analytics; Finance; Financial Planning and Wealth Management; Management; Management Information Systems; Marketing; Operations and Supply Chain Management] [PhD concentrations: Organizational Behavior; Strategic Management; Information Systems; Operations Management]	BU		●
Finance		●	
<b>Management*</b>		GP	
<b>Real Estate Development*</b>		GP	
Technology Management		●	
<b>School for Conflict Analysis and Resolution</b>			
<b>Conflict Analysis and Resolution*</b> [BA/BS concentrations: Building Peace in Divided Societies; Global Engagement; Political and Social Action; Justice and Reconciliation; Interpersonal Dynamics; Collaborative Leadership; Environmental Conflict and Collaboration; Individualized] [MS concentrations: <b>Conflict Sensitive Development and Resilience; Dynamics of Violence; Inclusive Conflict Engagement; Individualized; Media Narrative and Public Discourse; Social Justice Advocacy and Activism; Peacebuilding</b> ]	HD	GP	●
<b>Schar School of Policy and Government</b>			
▶ Biodefense [PhD concentrations: International Security; Terrorism and Homeland Security; Technology and Weapons of Mass Destruction]		●	●

	B	M	D
Government and International Politics [BA concentrations in government: American Institutions and Processes; Comparative Politics; International Political Economy; International Relations; Law, Philosophy and Governance; Philosophy, Politics and Economics; Political Analysis; Political Behavior and Identity Politics; Public Policy and Administration; Individualized] [BA concentrations in non-government: Philosophy, Politics and Economics]	HS		
<b>International Commerce and Policy*</b> [MA concentrations: <b>Global Development and Governance; Global Finance, Investment, and Trade; Global Risk and Strategy</b> ]		GP	
International Security [MA concentrations: Intelligence; Peace Operations; Transnational Challenges]		●	
Organization Development and Knowledge Management		●	
Political Science [MA concentrations: American Government and Politics; Comparative Politics; International Relations; International Security]		●	●
Public Administration [BS concentrations: Administration and Management; Public Policy; Nonprofit Management; US Government Institutions; Economic Policy Analysis; International Political Economy; Individualized] [MPA concentrations: Administration of Justice; Emergency Management and Homeland Security; Environmental Science and Public Policy; Human Resources Management; International Management; Managing Across Sectors; Nonprofit Management; Policy Studies; Public Management; Public and Nonprofit Finance; State and Local Government]	HS	●	
<b>Public Policy*</b>		GP	●
Transportation Policy, Operations and Logistics		●	

<b>College of Engineering and Computing</b>			
▶ Applied Computer Science [BS concentrations: Bioinformatics; Computer Game Design; Geoinformatics; Software Engineering]	EC		
▶ <b>Applied Information Technology*</b> [MS concentrations: <b>Cybersecurity; Cyber-Human Systems; Data Analytics and Intelligence Methods; IT Management</b> ]		GP	
▶ <b>Bioengineering*</b> [BS concentrations: Bioengineering Healthcare Informatics; Bioengineering Prehealth; Biomaterials and Nanomedicine; Biomedical Imaging and Devices; Computational Biomedical Engineering; Neurotechnology and Computational Neuroscience] [PhD concentrations: Biomedical Imaging and Devices; Computational Biomedical Engineering; Biomaterials and Nanomedicine; Neurotechnology and Computational Neuroscience]	EC	GP	●
▶ <b>Biostatistics*</b>		GP	
▶ <b>Civil and Infrastructure Engineering*</b> [MS concentrations: <b>Construction Engineering and Management; Environmental and Water Resources Engineering; Geotechnical Engineering; Structural Engineering; Transportation Engineering</b> ]	EC	GP	●
▶ <b>Computer Engineering*</b> [BS concentrations: Computer Networks; Embedded Systems; Hardware and System Security; Internet of Things; Robotics; Power and Energy Systems] [MS concentrations: <b>Computer Architecture and Embedded Systems; Computer Networks; Digital Signal Processing; Digital System Design; Hardware Security and Cryptographic Engineering; Internet of Things and Network Security; Machine Learning and Computer Engineering; Space-Based Systems</b> ]	EC	GP	
▶ <b>Computer Science*</b> [MS concentrations: <b>Cybersecurity; Machine Learning</b> ]	EC	GP	●
Cybersecurity Engineering [MS concentration: Secure Advanced Manufacturing and Supply Chains]	EC	●	
▶ <b>Data Analytics Engineering*</b> [MS concentrations: <b>Applied Analytics; Bioengineering; Business Analytics; Cyber Analytics; Data Mining; Financial Engineering; Health Data Analytics; Internet of Things; Predictive Analytics; Statistical Analytics</b> ]		GP	
▶ <b>Digital Forensics</b> [MS concentrations: <b>Penetration Testing/Reverse Engineering</b> ]		GP	
▶ Electrical and Computer Engineering			●
▶ <b>Electrical Engineering*</b> [BS concentrations: Controls and Robotics; Communications and Signal Processing; Electronics; Embedded Systems; Internet of Things; Power and Energy Systems] [MS concentrations: <b>Bioengineering; Communications and Networking; Control and Robotics; Electronics; Signal Processing; Space-Based Systems</b> ]	EC	GP	
▶ <b>Information Security and Assurance*</b> [MS concentrations: <b>Network and System Security; Applied Cybersecurity</b> ]		GP	
▶ <b>Information Systems*</b>		GP	
▶ Information Technology [BS concentrations: Database Technology and Programming; Health Information Technology; Cybersecurity; Network and Telecommunications; Web Application Development; Cloud Computing] [PhD concentrations: Information Security and Assurance, Information Science and Technology; Information Systems; Mechanical Engineering; Software Engineering]	EC		●
▶ Mechanical Engineering [BS optional concentration: Aerospace Engineering]	EC		
▶ <b>Operations Research</b> [MS concentrations: <b>Data Analytics; Decision Analysis; Financial Engineering; Military Operations Research; Optimization; Stochastic Models</b> ]		GP	
▶ <b>Software Engineering*</b>		GP	
▶ <b>Statistical Science*</b>		GP	●
▶ Statistics [BS concentrations: Applied Statistics; Mathematical Statistics; Sport Analytics; Statistical Analytics]	EC		
▶ <b>Systems Engineering</b> [MS concentrations: <b>Advanced Transportation Systems; Architecture-Based Systems Integration; Command, Control, Communications, Computing, and Intelligence; Energy Systems; Financial Systems Engineering; Systems Engineering and Data Analytics; Systems Engineering of Software-Intensive Systems; Systems Management</b> ]	EC	GP	
▶ Systems Engineering and Operations Research			●
▶ <b>Telecommunications*</b> [MS concentrations: <b>Network Technologies; Network Forensics and Security</b> ]		GP	

UNDERGRADUATE ADMISSIONS

We offer several routes to admission. With more than 80 bachelor's degrees, flexible study plans and start dates throughout the year, we will help you find the option that is right for you.

There is no need to stress about where you start; just focus on where you're going. We don't design our programs for one type of student; our programs are built for everyone. Where you begin depends on your grades and English level. Where you end up is where you want to be: graduating with a bachelor's degree from George Mason University.

→ **DIRECT ENTRY:** If you meet the academic and English language requirements for your degree program, you can apply directly to George Mason University.

To apply, you will need the following required documents: declarations, high school transcripts, university transcripts (for transfer applicants), proof of degree, personal statement, accounting of time, passport, English test score and personal statement (recommended). An application fee may apply. For more information, visit [catalog.gmu.edu/admissions/international-students](https://catalog.gmu.edu/admissions/international-students)

→ **INTERNATIONAL YEAR ONE:** International Year One allows you to begin earning credits toward your degree even if you do not meet the academic and English requirements for direct entry. You will receive additional academic, English language and cultural support to help you successfully complete your first year and graduate in the same amount of time as direct entry students. For more information, visit [www.intostudy.com/mason/programs](https://www.intostudy.com/mason/programs)

→ **ENGLISH LANGUAGE PROGRAM:** If you do not meet the direct or International Year One entry language requirements, you can enter our Academic English program to improve your academic and language skills. Once you have achieved the required language level, you can progress to International Year One or enter your degree program directly. Learn more on page 21.

Undergraduate Degree Program

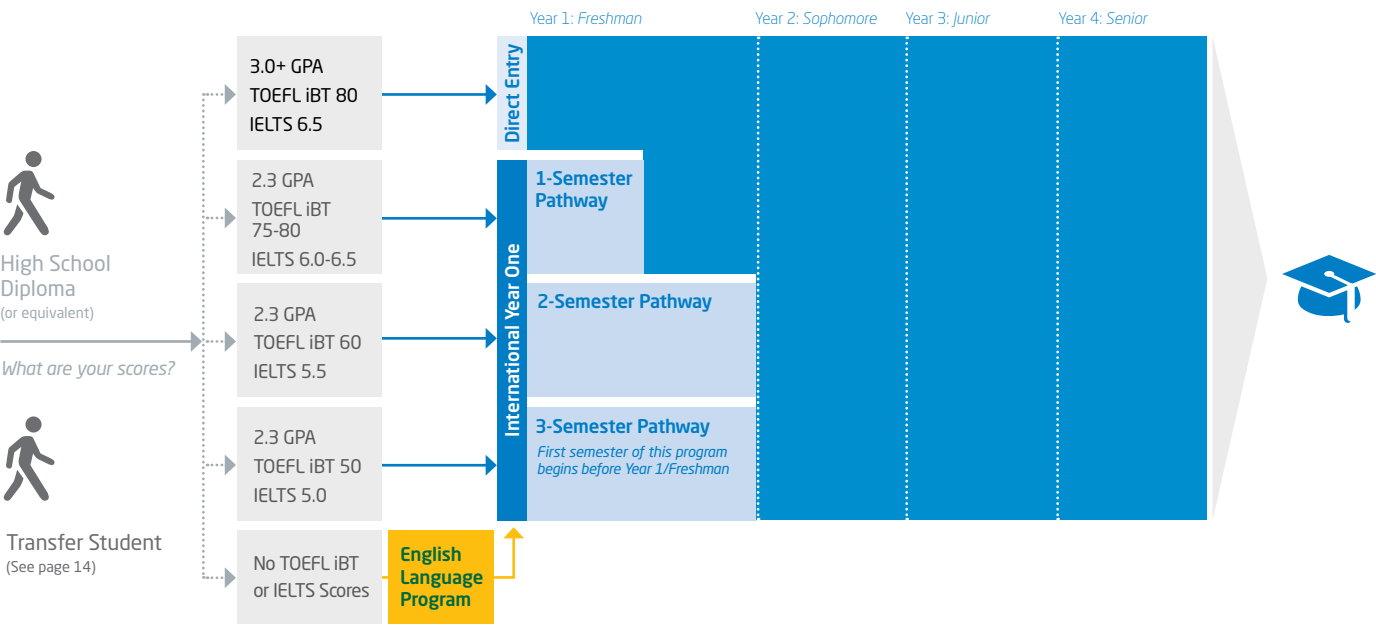

Entry Requirements				
PROGRAM	DIRECT*	INTERNATIONAL YEAR ONE**		
		1-SEMESTER	2-SEMESTER	3-SEMESTER
Program requirements	<ul style="list-style-type: none"><li>High school diploma</li><li>ACT/SAT may be required depending on program</li><li>Additional materials may also be required</li></ul>	High school diploma		
Minimum GPA Equivalent	3.0	2.3	2.3	2.3
TOEFL iBT	80 (18 in all subscores)	75-80 (17 subscores in reading and writing)	60 (13 subscores in reading and listening)	50 (10 in all subscores)
IELTS	6.5 (6.0 in all subscores)	6.0-6.5 (6.0 subscores in reading and writing)	5.5 (5.5 subscores in reading and listening)	5.0 (4.5 in all subscores)
IELA	176 (169 in all subscores)	165-175 (169 subscores in reading and writing)	155 (145 subscores in reading and listening)	145 (135 in all subscores)
Duolingo	110	100 <sup>1</sup>	90 <sup>1</sup>	80 <sup>1</sup>
Academic English	Level 6	Level 5	Level 4	Level 3
<b>Notes:</b> Entry requirements are subject to change and vary by program. SAT score of 500 on the evidence-based Reading and Writing section or ACT score of 20 for English and Writing may be used to waive English requirements for 1-Semester IYO. *Engineering, art, music and nursing programs may include additional requirements. TOEFL subscores are not required for the College of Engineering and Computing programs. **Subscores are not required for 1- and 2-Semester International Year One in Engineering, Computing and Statistics programs. Some programs may require additional entry requirements. <sup>1</sup> IELA exam may be required upon arrival, which will determine final study plan.				
Institutional Code	TOEFL: 5827	SAT: 5827	ACT: 4357	

Dates		
PROGRAM	DIRECT	INTERNATIONAL YEAR ONE
Start Dates	Fall 2022: Aug 2022 Spring 2023: Jan 2023	Fall 2022: Aug 15, 2022 Spring 2023: Jan 16, 2023

International Year One Programs

\* Estimated credits remaining after Pathway/Total credit hours needed to complete degree.

\*\*For English Language tests subscores, please see entry requirements table on page 12 .

Semester(s)	Start Dates		Credits*	Entry Requirements: ** High School Diploma					Progression Requirements All GPAs are minimum cumulative	
	Fall	Spring		GPA	TOEFL iBT	IELTS	IELA	Duolingo <sup>1</sup>	GPA	Other
Business										
3-Semester	•	•	91-94/120	2.3	50	5.0	145	80	2.85	<ul style="list-style-type: none"><li>• C or better in all courses</li><li>• No grades of NC, W or IN permitted</li></ul>
2-Semester	•	•	91-94/120		60	5.5	155	90		
1-Semester	•	•	105/120		80	6.5	175	100		
Engineering, Computing and Statistics <sup>3</sup>										
3-Semester	•	•	93-103/120+	2.3	50	5.0	145	80	2.75	<ul style="list-style-type: none"><li>• B- or better in MATH, CS, IT, ENGR, PHYS and STAT courses</li><li>• C or better in other courses</li><li>• No grades of NC, W or IN permitted</li></ul>
2-Semester	•	•	93-103/120+		60 <sup>2</sup>	5.5 <sup>2</sup>	155 <sup>2</sup>	90		
1-Semester	•	•	104-105+/120+		75 <sup>2</sup>	6.0 <sup>2</sup>	165 <sup>2</sup>	100		
Human and Social Development										
3-Semester	•	•	91-94/120	2.3	50	5.0	145	80	2.5	<ul style="list-style-type: none"><li>• C or better in all courses</li><li>• No grades of NC, W or IN permitted</li></ul>
2-Semester	•	•	91-94/120		60	5.5	155	90		
1-Semester	•	•	105/120		80	6.5	175	100		
Humanities and Social Sciences										
3-Semester	•	•	88-90/120	2.3	50	5.0	145	80	2.5	<ul style="list-style-type: none"><li>• C or better in all courses</li><li>• No grades of NC, W or IN permitted</li></ul>
2-Semester	•	•	88-90/120		60	5.5	155	90		
1-Semester	•	•	104-105/120		80	6.5	175	100		
Science										
3-Semester	•	•	82-86/120	2.3	50	5.0	145	80	2.5	<ul style="list-style-type: none"><li>• C or better in all courses</li><li>• No grades of NC, W or IN permitted</li></ul>
2-Semester	•	•	82-86/120		60	5.5	155	90		
1-Semester	•	•	102/120		80	6.5	175	100		

Entry and progression requirements are subject to change and may vary by program. Some programs may require additional items to apply.

<sup>1</sup>IELA exam may be required upon arrival, which will determine final study plan.

<sup>2</sup>No subscores required

<sup>3</sup>Some programs will require more than 120 total credits to complete the degree

[SAMPLE INTERNATIONAL YEAR ONE PROGRAM] Business				
2-Semester Pathway		Degree Program Components		Program Information
Fall: August 15, 2022 Spring: January 16, 2023		120 credit hour program 26-29 credit hours apply from Pathway 91-94 credit hours remaining toward degree		
<b>Entry Requirements</b>		<b>Semester 1</b>	<b>Course Title</b>	<b>Credit Hours</b>
<ul style="list-style-type: none"><li>High school diploma with 2.3 minimum high school GPA equivalent</li><li>Language requirement:<ul style="list-style-type: none"><li>TOEFL iBT 60 (13 subscores in reading and listening)</li><li>IELTS 5.5 (5.5 subscores in reading and listening)</li><li>IELA 155 (145 subscores in reading and listening)</li><li>Duolingo 90<sup>1</sup></li></ul></li></ul>		ENGH 121	Enhanced Composition For Multilingual Writers of English I	3
		MATH 108	Introductory Calculus with Business Applications	3
		INYO 105	American Cultures	3
		EAP 102	Language Support for American Cultures	1
		BUS 100	Business and Society	3
		EAP 108	Language Support for Business in Society	1
		INYO 100	Transition INTO Mason I	1
		Total		15
		<b>Semester 2</b>	<b>Course Title</b>	<b>Credit Hours</b>
		ENGH 122	Enhanced Composition For Multilingual Writers of English II	3
COMM 101	Fundamentals of Communication	3		
EAP 101	Language Support for Fundamentals of Communication	1		
ECON 103	Contemporary Microeconomic Principles	3		
BUS 210 <sup>1</sup>	Business Analytics I	3		
INYO 101	Transition INTO Mason II	1		
Total		11-14		
1-Semester Pathway		Degree Program Components		
Fall: August 15, 2022 Spring: January 16, 2023		120 credit hour program 15 credit hours apply from Pathway 105 credit hours remaining toward degree		
<b>Entry Requirements</b>		<b>Semester 1</b>	<b>Course Title</b>	<b>Credit Hours</b>
<ul style="list-style-type: none"><li>High school diploma with 2.3 minimum high school GPA equivalent</li><li>Language requirement:<ul style="list-style-type: none"><li>TOEFL iBT 80 (17 subscores in reading and writing)</li><li>IELTS 6.5 (6.0 subscores in reading and writing)</li><li>IELA 175 (165 subscores in reading and writing)</li><li>Duolingo 100<sup>1</sup></li></ul></li></ul>		ENGH 100	Composition for Multilingual Writers	4
		MATH 108	Introductory Calculus with Business Applications	3
		BUS 100	Business and Society	3
		EAP 108	Language Support for Business in Society	1
		ECON 103	Contemporary Microeconomic Principles	3
		UNIV 100	Introduction to Mason	1
		Total		15
<b>Progression Requirements</b>		<ul style="list-style-type: none"><li>2.85 cumulative Mason GPA</li><li>C or better in all courses</li><li>No grades of NC, W or IN permitted</li></ul> <b>Notes</b> <sup>1</sup> This course is offered to students beginning in the Fall term only. <b>These courses are generally delivered through INTO Mason and are for Pathway students only.</b>		

[business.gmu.edu/undergraduate](https://business.gmu.edu/undergraduate)

<sup>1</sup>IELA exam may be required upon arrival, which will determine final study plan.



US UNDERGRADUATE EDUCATION SYSTEM

To graduate with your 4-year undergraduate degree, you will need to take the following classes:

**Core classes:** General education courses can include English composition, social sciences, humanities, history, mathematics and natural/physical science. These are typically taken at the beginning of your degree.

**Major classes:** These classes will be about the specific field of study you choose. They are typically taken toward the last part of your degree.





## UNDERGRADUATE TRANSFER PROGRAM >>

Have you earned credits from an international college or university and want to transfer to a US university? You can transfer directly into George Mason University or choose our Undergraduate Transfer Program (UTP), which is specifically designed to support international students through the process of transferring.

Entry Requirements**		
PROGRAM	DIRECT TRANSFER	UNDERGRADUATE TRANSFER PROGRAM
Program length	Varies	1-Semester and 2-Semesters
Start Dates	Fall: Aug 2022 Spring: Jan 2023	Fall: Aug 15, 2022 Spring: Jan 16, 2023
GPA	2.85	2.0*
TOEFL iBT	80 (1.8 in all subscores)	60-80 (1.3-1.7 subscores in reading and writing)
IELTS	6.5 (6.0 in all subscores)	5.5-6.5 (5.5-6.0 subscores in reading and writing)
IELA	176 (1.69 in all subscores)	155-175 (1.45-1.65 subscores in reading and writing)
Duolingo	110	90-100 (IELA may be required upon arrival)
Minimum Transfer Credits	No minimum	1 credit-bearing university course
Maximum Transfer Credits	2-year college: 75 4-year college: 90	90

Entry requirements are subject to change and vary by program.  
\*GPA varies. Comprehensive review of application completed for UTP students.  
\*\*Courses completed 10+ years prior will not be included for majors within College of Engineering and Computing or School of Business.

### Why Choose UTP?

Choosing UTP provides a customized, cost-effective path to your bachelor's degree. Before your program starts, Mason will provide you with an estimate of credits that will transfer to the university. Once you arrive on campus, our friendly staff will be available to help you transition into life at a US university. You will also have access to helpful resources including academic, English language and cultural support. If you do not meet the English language entry requirements for the UTP, you can enter our Academic English program before progressing to either the UTP or direct transfer to Mason.

### Undergraduate Transfer Program Benefits

- Transfer of credits from your college or university-level classes to your degree
- Receive customized curriculum of university credit-bearing courses
- Quick turnaround time for offer (5-7 business days)
- Unofficial Pre-arrival Credit Evaluation (15 additional business days after receiving offer letter) and official credit evaluation during first semester at Mason
- Guaranteed progression to any undergraduate program available through International Year One
- Academic advising and support throughout the program including assistance transferring credit out of UTP into degree program

Undergraduate Transfer Program Start Dates		
PROGRAM	Fall: Aug 15, 2022	Spring: Jan 16, 2023
Business	●●	●●
Engineering, Computing and Statistics	●●	●●
Human and Social Development	●●	●●
Humanities and Social Sciences	●●	●●
Science	●●	●●

● 1-Semester program ● 2-Semester program

## GRADUATE ADMISSIONS >>

As a graduate student, you can pursue research among world-renowned faculty and access diverse career opportunities in the Washington, DC area. There are several paths to earn your master's degree at Mason.

How you start your program depends on your academic profile and your English level. How you finish your program is exactly how you pictured: graduating with a master's degree or PhD from Mason.

→ **Direct Entry:** If you meet the academic and English language requirements for your degree program, you can apply directly to Mason.

To apply, you will need the following required documents: declarations, university transcripts, proof of degree, accounting of time, passport, English test score and personal statement. An application fee may apply. Additional requirements such as previous work experience and a portfolio are required for select programs.

Graduate degrees are competitive, and an extensive review of your application will be done. Please expect a longer turnaround for an admissions decision. For more information, visit [catalog.gmu.edu/admissions/international-students](https://catalog.gmu.edu/admissions/international-students)

→ **Graduate Pathway:** Our Graduate Pathways allow you to begin earning credits toward your degree even if you do not meet the academic and English requirements for direct entry. The program will help build the academic foundation and essential English language skills you need to successfully progress to your master's degree. For more information, visit [www.intostudy.com/mason/programs](https://www.intostudy.com/mason/programs)

→ **English Language Program:** If you do not meet the direct or Graduate Pathway program entry language requirements, you can enter our Academic English program to improve your academic and language skills. Once you have achieved the required language level, you can progress to a Graduate Pathway program or enter your degree program directly. Learn more on page 21.

PROGRAM	DIRECT	GRADUATE PATHWAY	
		1-SEMESTER	2-SEMESTER
Program requirements	<ul style="list-style-type: none"><li>• 4-year undergraduate degree or higher</li><li>• Minimum GRE, GMAT or other scores if required by program</li><li>• Additional materials may also be required (vary by program)</li></ul>	4-year undergraduate degree	
Minimum GPA Equivalent	3.0	2.75	2.75
TOEFL iBT	88 (20 in all subscores)	80 (1.7 in all subscores)	70 (1.5 in all subscores)
IELTS	7.0 (6.5 in all subscores)	6.5 (6.0 in all subscores)	6.0 (5.5 in all subscores)
IELA	180 (1.70 in all subscores)	170 (1.60 in all subscores)	160 (1.50 in all subscores)
Duolingo	120	110 <sup>1</sup>	100 <sup>1</sup>
Academic English	Level 7	Level 6	Level 5

**Notes:** Entry requirements are subject to change and may vary by program. Some programs may require additional materials to apply.  
<sup>1</sup>IELA exam may be required upon arrival, which will determine final study plan.  
\*For all schools and colleges except the College of Engineering and Computing

Entry Requirements - College of Engineering and Computing			
PROGRAM	DIRECT	GRADUATE PATHWAY	
		1-SEMESTER	2-SEMESTER
Program requirements	<ul style="list-style-type: none"><li>• 4-year undergraduate degree or higher</li><li>• Minimum GRE, GMAT or other scores if required by program</li><li>• Additional materials may also be required (vary by program)</li></ul>	4-year undergraduate degree	
Minimum GPA Equivalent	3.0	2.75	2.75
TOEFL iBT	80	75	65
IELTS	6.5	6.0	5.5
IELA	176	165	155
Duolingo	120	110 <sup>1</sup>	100 <sup>1</sup>
Academic English	Level 7	Level 6	Level 5

**Notes:** Entry requirements are subject to change and may vary by program. Some programs may require additional materials to apply. Subscores are not required for College of Engineering and Computing programs.  
<sup>1</sup>IELA exam may be required upon arrival, which will determine final study plan.

DATES		
PROGRAM	DIRECT	GRADUATE PATHWAY
Start Dates	Fall 2022: Aug 2022 Spring 2023: Jan 2023	Fall 2022: Aug 15, 2022 Spring 2023: Jan 16, 2023

Institutional Code	TOEFL: 5827	GRE: 5827	GMAT: 5827
--------------------	-------------	-----------	------------





Graduate Pathway Programs

\* Estimated credits remaining after Pathway/Total credit hours needed to complete degree.

Semester	Start Dates		Credits*	Entry Requirements					Progression Requirements			
	Fall	Spring		GPA	Undergraduate Degree	TOEFL iBT	IELTS	IELA	Duolingo <sup>1</sup>	All GPAs are minimum cumulative	GPA	Other
Accounting												
3-Semester	•	•	30/30	2.75	4-year undergraduate degree or equivalent in business or related degree	60 (1.3 in all subscores)	5.5 (5.5 in all subscores)	150 (150 in all subscores)	90	3.0	<ul style="list-style-type: none"><li>• B or better in all course work</li><li>• Statement of purpose</li><li>• 2 recommendation forms, preferably one from a School of Business faculty member</li></ul>	
2-Semester	•	•	30/30			70 (1.5 in all subscores)	6.0 (5.5 in all subscores)	160 (150 in all subscores)	100			
Applied and Engineering Physics [Concentrations: Standard Physics , Applied Physics, Engineering Physics, Quantum Information Science and Engineering]												
2-Semester	•	•	24/30	2.75	4-year undergraduate degree or equivalent in physics or applied physics	70 (1.5 in all subscores)	6.0 (5.5 in all subscores)	160 (150 in all subscores)	100	3.0	<ul style="list-style-type: none"><li>• B or better in all course work</li><li>• Statement of purpose</li><li>• 3 recommendation forms</li></ul>	
1-Semester	•		24/30			80 (1.7 in all subscores)	6.5 (6.0 in all subscores)	170 (160 in all subscores)	110			
Applied Information Technology [MS concentrations: Cybersecurity; Cyber-Human Systems; Data Analytics and Intelligence Method; IT Management]												
2-Semester	•	•	24/30	2.75	4-year undergraduate degree or equivalent in computer science, information technology or related technical or management fields	65	5.5	155	100	3.0	<ul style="list-style-type: none"><li>• B or better in all course work</li><li>• Statement of purpose</li><li>• 2 recommendation forms</li></ul>	
1-Semester	•	•	24/30			75	6.0	165	110			
Arts Management												
2-Semester	•	•	25/36	2.75	4-year undergraduate degree or equivalent in related field (theater, music performance, conducting, literature, dance, art history, film studies, studio art and graphic design, arts management, cultural management, marketing/communications and management/business)	70 (1.5 in all subscores)	6.0 (5.5 in all subscores)	160 (150 in all subscores)	100	3.0	<ul style="list-style-type: none"><li>• B or better in all course work</li><li>• Statement of purpose</li><li>• 1 recommendation form from Arts Management Program Director</li></ul>	
Bioengineering												
2-Semester	•	•	24-27/30-33	2.75	4-year undergraduate degree or equivalent in Bioengineering or related field	65	5.5	155	100	3.0	<ul style="list-style-type: none"><li>• B or better in all course work</li><li>• Statement of purpose</li><li>• 3 recommendation forms</li></ul>	
1-Semester	•	•	24-27/30-33			75	6.0	165	110			
Bioinformatics and Computational Biology												
2-Semester	•	•	25/31	2.75	4-year undergraduate degree or equivalent in biology, mathematics, statistics or bioengineering	70 (1.5 in all subscores)	6.0 (5.5 in all subscores)	160 (150 in all subscores)	100	3.0	<ul style="list-style-type: none"><li>• B or better in all course work</li><li>• Statement of purpose</li><li>• 3 recommendation forms</li></ul>	
1-Semester	•	•	25/31			80 (1.7 in all subscores)	6.5 (6.0 in all subscores)	170 (160 in all subscores)	110			
Bioinformatics Management												
2-Semester	•	•	24/30	2.75	4-year undergraduate degree or equivalent in biology, mathematics, statistics or bioengineering	70 (1.5 in all subscores)	6.0 (5.5 in all subscores)	160 (150 in all subscores)	100	3.0	<ul style="list-style-type: none"><li>• B or better in all course work</li><li>• Statement of purpose</li><li>• 3 recommendation forms</li></ul>	
1-Semester	•	•	24/30			80 (1.7 in all subscores)	6.5 (6.0 in all subscores)	170 (160 in all subscores)	110			
Biostatistics												
2-Semester	•	•	30/36	2.75	<ul style="list-style-type: none"><li>• 4-year undergraduate degree or equivalent</li><li>• Related fields include statistics or any field which includes course work in multivariable calculus, matrix or linear algebra, statistics and calculus-based probability. Students entering the program must have completed the equivalent to mathematic and statistic courses. **</li></ul>	65	5.5	155	100	3.0	<ul style="list-style-type: none"><li>• B or better in all course work</li><li>• Statement of purpose</li><li>• 2 recommendation forms</li></ul>	
1-Semester	•	•	30/36			75	6.0	165	110			
Business Administration (MBA) [Emphases: Accounting; Business Analytics; Entrepreneurship; Financial Management; International Business; Leadership; Marketing; Project Management; Government Contracting]												
2-Semester	•	•	42/48	2.75	<ul style="list-style-type: none"><li>• 4-year undergraduate degree or equivalent</li><li>• The program requires the equivalent of two years of post-graduate full-time professional work experience</li><li>• Work experience does not need to be business-based and can include teaching, military service or government experience</li></ul>	70 (1.5 in all subscores)	6.0 (5.5 in all subscores)	160 (150 in all subscores)	100	3.0	<ul style="list-style-type: none"><li>• B or better in all course work</li><li>• Statement of purpose</li><li>• 2 recommendation forms, preferably one from a School of Business faculty member</li></ul>	
1-Semester	•	•	45/48			80 (1.7 in all subscores)	6.5 (6.0 in all subscores)	170 (160 in all subscores)	110			
Civil and Infrastructure Engineering [MS concentrations: Construction Engineering and Management; Environmental and Water Resources Engineering; Geotechnical Engineering; Structural Engineering; Transportation Engineering]												
2-Semester	•	•	24/30	2.75	<ul style="list-style-type: none"><li>• 4-year undergraduate degree or equivalent</li><li>• Relevant undergraduate degrees vary depending on specific program concentration.†</li></ul>	65	5.5	155	100	3.0	<ul style="list-style-type: none"><li>• B or better in all course work</li><li>• Statement of purpose</li><li>• 2 recommendation forms</li></ul>	
1-Semester	•	•	24/30			75	6.0	165	110			
Communication [MA specializations: Science Communication; Strategic Communication/Public Relations; Health Communication; Individualized]												
2-Semester	•		24/33	2.75	4-year undergraduate degree or equivalent	70 (1.5 in all subscores)	6.0 (5.5 in all subscores)	160 (150 in all subscores)	100	3.0	<ul style="list-style-type: none"><li>• B or better in all course work</li><li>• Statement of purpose</li><li>• 2 recommendation forms</li></ul>	
1-Semester	•		27/33			80 (1.7 in all subscores)	6.5 (6.0 in all subscores)	170 (160 in all subscores)	110			
Computational Science												
2-Semester	•	•	24/30	2.75	4-year undergraduate degree or equivalent in mathematics or statistics	70 (1.5 in all subscores)	6.0 (5.5 in all subscores)	160 (150 in all subscores)	100	3.0	<ul style="list-style-type: none"><li>• B or better in all course work</li><li>• Statement of purpose</li><li>• 3 recommendation forms</li></ul>	
1-Semester	•	•	24/30			80 (1.7 in all subscores)	6.5 (6.0 in all subscores)	170 (160 in all subscores)	110			

Entry and progression requirements are subject to change and may vary by program.  
<sup>1</sup>IELA exam may be required upon arrival, which will determine final study plan.  
<sup>\*\*</sup>To see the full list of courses please visit [partnerportal.intoglobal.com/Course-Information/george-mason-university/graduate-pathway-in-biostatistics](https://partnerportal.intoglobal.com/Course-Information/george-mason-university/graduate-pathway-in-biostatistics)  
<sup>†</sup>Please view accepted degrees at [partnerportal.intoglobal.com/University-Information/george-mason-university](https://partnerportal.intoglobal.com/University-Information/george-mason-university)

Semester	Start Dates		Credits*	Entry Requirements					Progression Requirements All GPAs are minimum cumulative		
	Fall	Spring		GPA	Undergraduate Degree	TOEFL iBT	IELTS	IELA	Duolingo¹	GPA	Other
Computer Engineering											
2-Semester	•	•	24/30	2.75	4-year undergraduate degree or equivalent in computer engineering, computer science, electrical engineering, electronics and communications, electronic engineering or a closely related discipline from an accredited program	65	5.5	155	100	3.0	• B or better in all course work • Statement of purpose • 2 recommendation forms
1-Semester	•	•	24/30			75	6.0	165	110		
Computer Science [MS concentrations: Cybersecurity; Machine Learning]											
2-Semester	•	•	24/30	2.75	• 4-year undergraduate degree in computer science or related field (computer science or computer engineering, software engineering and mathematics)  • Degree must include Data Structures and Algorithms, Automata Theory and Formal Languages, Computer Architecture, including Assembly Language  • Completion of Calculus I and II and a course in discrete mathematics	65	5.5	155	100	3.0	• B or better in all course work • Statement of purpose • 2 recommendation forms
1-Semester	•	•	24/30			75	6.0	165	110		
Conflict Analysis and Resolution [MS concentrations: Conflict Sensitive Development and Resilience; Dynamics of Violence; Inclusive Conflict Engagement; Individualized; Media Narrative and Public Discourse; Social Justice Advocacy and Activism; Peacebuilding]											
2-Semester	•	•	30/42	2.75	4-year undergraduate degree or equivalent	70 (1.5 in all subscores)	6.0 (5.5 in all subscores)	160 (150 in all subscores)	100	3.0	• B or better in all course work • Statement of purpose • 2 recommendation forms
1-Semester	•	•	36/42			80 (1.7 in all subscores)	6.5 (6.0 in all subscores)	170 (160 in all subscores)	110		
Curriculum and Instruction [MEd concentrations Early Childhood and Elementary Education]											
2-Semester	•	•	21/30	2.75	4-year undergraduate degree or equivalent	70 (1.5 in all subscores)	6.0 (5.5 in all subscores)	160 (150 in all subscores)	100	3.0	• B or better in all course work • Statement of purpose • 2 recommendation forms
1-Semester	•	•	24/30			80 (1.7 in all subscores)	6.5 (6.0 in all subscores)	170 (160 in all subscores)	110		
Data Analytics Engineering [MS concentrations: Applied Analytics, Bioengineering, Business Analytics, Cyber Analytics, Data Mining, Financial Engineering, Health Data Analytics, Internet of Things, Predictive Analytics, Statistical Analytics]											
2-Semester	•	•	24/30	2.75	• 4-year undergraduate degree in engineering, business, computer science, statistics, mathematics or information technology  • Applicants may demonstrate strong work experience with data or analytics instead of related degree	65	5.5	155	100	3.0	• B or better in all course work • Statement of purpose • 2 recommendation forms
1-Semester	•	•	24/30			75	6.0	165	110		
Digital Forensics [MS concentration: Penetration Testing/Reverse Engineering]											
2-Semester	•	•	24/30	2.75	• 4-year undergraduate degree or equivalent in the areas of computer science, computer engineering, information technology, business, economics or related discipline  • Completion of course work in: TCP/IP, Computer Operating Systems, Computer Networking and Network Routing	65	5.5	155	100	3.0	• B or better in all course work • Statement of purpose • 3 recommendation forms
1-Semester	•	•	24/30			75	6.0	165	110		
Earth Systems Science											
2-Semester	•	•	21/30	2.75	4-year undergraduate degree or equivalent in geography, geology, earth science, computer and information systems, forestry cultivation, forest engineering, petroleum and gas engineering, zoology	70 (1.5 in all subscores)	6.0 (5.5 in all subscores)	160 (150 in all subscores)	100	3.0	• B or better in all course work • Statement of purpose • Recommendation form from ESS faculty member
1-Semester	•	•	24/30			80 (1.7 in all subscores)	6.5 (6.0 in all subscores)	170 (160 in all subscores)	110		
Economics											
2-Semester	•		21/30	2.75	4-year undergraduate degree or equivalent	70 (1.5 in all subscores)	6.0 (5.5 in all subscores)	160 (150 in all subscores)	100	3.0	• B or better in all course work • Statement of purpose • 2 recommendation forms
1-Semester	•		24/30			80 (1.7 in all subscores)	6.5 (6.0 in all subscores)	170 (160 in all subscores)	110		
Educational Psychology [MS concentrations: Assessment, Evaluation and Testing; Learning, Cognition and Motivation]											
2-Semester	•	•	21/30	2.75	4-year undergraduate degree or equivalent	70 (1.5 in all subscores)	6.0 (5.5 in all subscores)	160 (150 in all subscores)	100	3.0	• B or better in all course work • Statement of purpose • 2 recommendation forms
1-Semester	•	•	24/30			80 (1.7 in all subscores)	6.5 (6.0 in all subscores)	170 (160 in all subscores)	110		
Electrical Engineering											
2-Semester	•	•	24-30/30-36	2.75	4-year undergraduate degree or equivalent in electrical engineering, electronics and communications, electronic engineering, computer engineering or a closely related field	65	5.5	155	100	3.0	• B or better in all course work • Statement of purpose • 2 recommendation forms
1-Semester	•	•	24-30/30-36			75	6.0	165	110		
English [MA concentrations: Linguistics]											
2-Semester	•	•	30/36	2.75	• 4-year undergraduate degree or equivalent in related field  • Related fields include english, ESL, linguistics and language acquisition	70 (1.5 in all subscores)	6.0 (5.5 in all subscores)	160 (150 in all subscores)	100	3.0	• B or better in all course work • Statement of purpose • 2 recommendation forms
Environmental Science and Policy [MS concentrations: Aquatic Ecology; Conservation Science and Policy; Environmental Science and Policy; Communication for Environmental Science, Policy and Human Behavior; Environment and Management; Energy and Sustainability Policy and Science; Conservation Medicine and Planetary Health]											
2-Semester	•	•	37/37	2.75	• 4-year undergraduate degree or equivalent in related field  • Related fields include environmental studies, earth science, biology, ecology, botany, and sustainability studies	70 (1.5 in all subscores)	6.0 (5.5 in all subscores)	160 (150 in all subscores)	100	3.0	• B or better in all course work • Statement of purpose • 3 recommendation forms
1-Semester	•	•	31/37			80 (1.7 in all subscores)	6.5 (6.0 in all subscores)	170 (160 in all subscores)	110		

Entry and progression requirements are subject to change and may vary by program.  
<sup>1</sup>IELA exam may be required upon arrival, which will determine final study plan.



Graduate Pathway Programs (continued)

\* Estimated credits remaining after Pathway/Total credit hours needed to complete degree.

Semester	Start Dates		Credits*	Entry Requirements					Progression Requirements All GPAs are minimum cumulative		
	Fall	Spring		GPA	Undergraduate Degree	TOEFL iBT	IELTS	IELA	Duolingo <sup>1</sup>	GPA	Other
Forensic Science [MS concentrations: Crime Scene Investigation; Forensic Biology Analysis; Forensic Chemistry Analysis; Forensic/Biometric Identity Analysis]											
2-Semester	•	•	27/36	2.75	• 4-year undergraduate degree or equivalent in related field	70 (15 in all subscores)	6.0 (5.5 in all subscores)	160 (150 in all subscores)	100	3.0	• B or better in all course work • Statement of purpose • 3 recommendation forms
1-Semester	•	•	30/36		• Related fields include criminology and psychology; successful students in this major have diverse science and social science-related backgrounds	80 (17 in all subscores)	6.5 (6.0 in all subscores)	170 (160 in all subscores)	110		
Geographic and Cartographic Sciences											
2-Semester	•	•	20-26/30-36	2.75	4-year undergraduate degree in geography, geology, earth science, civil engineering, computer science, computer and information systems, geomatic engineering, information engineering	70 (15 in all subscores)	6.0 (5.5 in all subscores)	160 (150 in all subscores)	100	3.0	• B or better in all course work • Statement of purpose • Recommendation form from GCS faculty member
1-Semester	•	•	24-30/30-36			80 (17 in all subscores)	6.5 (6.0 in all subscores)	170 (160 in all subscores)	110		
Global Affairs [MA specializations: Global Conflict and Security; Global Culture and Society; Global Economics and Development; Global Education; Global Governance and Public Management; Global Health; Global Media and Information Technology; Global Population and Geography]											
2-Semester	•	•	21/30	2.75	4-year undergraduate degree or equivalent	70 (15 in all subscores)	6.0 (5.5 in all subscores)	160 (150 in all subscores)	100	3.0	• B or better in all course work • Statement of purpose • 2 recommendation forms
1-Semester	•	•	24/30			80 (17 in all subscores)	6.5 (6.0 in all subscores)	170 (160 in all subscores)	110		
Health Informatics [MS concentrations: Health Data Analytics; Health Informatics Management; Population Health Informatics]											
2-Semester	•	•	28-33/34-39	2.75	• 4-year undergraduate degree or equivalent in related field	70 (15 in all subscores)	6.0 (5.5 in all subscores)	160 (150 in all subscores)	100	3.0	• B or better in all course work • Statement of purpose • 2 recommendation forms
1-Semester	•	•	28-33/34-39		• Related fields include information systems, health policy and health services	80 (17 in all subscores)	6.5 (6.0 in all subscores)	170 (160 in all subscores)	110		
Health Systems Management											
2-Semester	•	•	40-41/46-47	2.75	• 4-year undergraduate degree or equivalent in related field	70 (15 in all subscores)	6.0 (5.5 in all subscores)	160 (150 in all subscores)	100	3.0	• B or better in all course work • Statement of purpose • 2 recommendation forms
1-Semester	•	•	40-41/46-47		• Related fields include public administration, health policy, health services, business, economics and nursing	80 (17 in all subscores)	6.5 (6.0 in all subscores)	170 (160 in all subscores)	110		
Information Security and Assurance [MS concentrations: Network and System Security, Applied Cybersecurity]											
2-Semester	•	•	24/30	2.75	• 4-year undergraduate degree in computer science or related field (computer science or computer engineering, software engineering and mathematics)	65	5.5	155	100	3.0	• B or better in all course work • Statement of purpose • 2 recommendation forms.
1-Semester	•	•	24/30		• Degree must include Data Structures and Algorithms, Automata Theory and Formal Languages, Computer Architecture, including Assembly Language • Completion of Calculus I and II and a course in discrete mathematics	75	6.0	165	110		
Information Systems											
2-Semester	•	•	24/30	2.75	• 4-year undergraduate degree in related field (computer science, computer engineering, software engineering and mathematics )	65	5.5	155	100	3.0	• B or better in all course work • Statement of purpose • 2 recommendation forms.
1-Semester	•	•	24-27/30		• Courses including Data Structures and Algorithms, Automata Theory and Formal Languages, Computer Architecture, Assembly Language with min of B. • Completion of Calculus I and II and course in discrete mathematics	75	6.0	165	110		
International Commerce and Policy [MA concentrations: Global Development and Governance; Global Finance, Investment and Trade; Global Risk and Strategy]											
2-Semester	•	•	27/36	2.75	4-year undergraduate degree or equivalent	70 (15 in all subscores)	6.0 (5.5 in all subscores)	160 (150 in all subscores)	100	3.0	• B or better in all course work • Statement of purpose • 2 recommendation forms
Management											
2-Semester	•	•	30/36	2.75	4-year undergraduate degree or equivalent	70 (15 in all subscores)	6.0 (5.5 in all subscores)	160 (150 in all subscores)	100	3.0	• B or better in all course work • Statement of purpose • 2 recommendation forms, preferably one from a School of Business faculty member
1-Semester	•	•	33/36			80 (17 in all subscores)	6.5 (6.0 in all subscores)	170 (160 in all subscores)	110		
Mathematics											
2-Semester	•	•	24-30/30	2.75	4-year undergraduate degree or equivalent in mathematics or statistics	70 (15 in all subscores)	6.0 (5.5 in all subscores)	160 (150 in all subscores)	100	3.0	• B or better in all course work • No grades of NC, W, or IN permitted • 2 recommendation forms
Music [MM concentrations: Jazz Studies, Performance]											
2-Semester		•	20/30	2.75	• 4-year undergraduate degree or equivalent in music performance, conducting, ethnomusicology, music education, music theory, composition or jazz studies	70 (15 in all subscores)	6.0 (5.5 in all subscores)	160 (150 in all subscores)	100	3.0	• B or better in all course work • Statement of purpose • 2 recommendation forms
1-Semester	•		23/30		• Audition (Video recordings must be submitted at the time of application) <sup>2</sup>	80 (17 in all subscores)	6.5 (6.0 in all subscores)	170 (160 in all subscores)	110		
Nutrition											
2-Semester	•	•	33/39	2.75	• 4-year undergraduate degree or equivalent in related field	70 (15 in all subscores)	6.0 (5.5 in all subscores)	160 (150 in all subscores)	100	3.0	• A in NUTR 295 • B or better in all course work • Statement of purpose • 2 recommendation forms
1-Semester	•	•	36/39		• Related fields include nursing, health sciences, agricultural studies, public health and education	80 (17 in all subscores)	6.5 (6.0 in all subscores)	170 (160 in all subscores)	110		

Entry and progression requirements are subject to change and may vary by program.

<sup>1</sup>IELA exam may be required upon arrival, which will determine final study plan.

<sup>2</sup>For specific audition requirements, please visit [partnerportal.intoglobal.com/Course-Information/george-mason-university/graduate-pathway-in-music](https://partnerportal.intoglobal.com/Course-Information/george-mason-university/graduate-pathway-in-music)

Semester	Start Dates		Credits*	Entry Requirements					Progression Requirements All GPAs are minimum cumulative		
	Fall	Spring		GPA	Undergraduate Degree	TOEFL iBT	IELTS	IELA	Duolingo¹	GPA	Other
Operations Research [MS concentrations: Data Analytics, Decision Analysis, Financial Engineering, Military Operations Research, Optimization, Stochastic Models]											
2-Semester	•	•	24-27/30-33	2.75	• 4-year undergraduate degree or equivalent in engineering, mathematics, computer science, physical sciences or economics • Completion of following courses required: multivariate calculus, linear algebra, calculus-based probability and statistics and a computer programming course with B or better	65	5.5	155	100	3.0	• B or better in all course work • Statement of purpose • Recommendation form
1-Semester	•	•	24-27/30-33			75	6.0	165	110		
Public Health [MPH concentrations: Community Health Promotion; Epidemiology; Food Security and Nutrition; Global Health; Health Policy; Public Health Communication; Public Health Practice]											
2-Semester	•		33/42	2.75	4-year undergraduate degree in a health-related field or equivalent	70 (15 in all subscores)	6.0 (5.5 in all subscores)	160 (150 in all subscores)	100	3.0	• B or better in all course work • Statement of purpose • 2 recommendation forms
1-Semester	•		36/42			80 (17 in all subscores)	6.5 (6.0 in all subscores)	170 (160 in all subscores)	110		
Public Policy											
2-Semester	•	•	27-30/36-39	2.75	4-year undergraduate degree or equivalent	70 (15 in all subscores)	6.0 (5.5 in all subscores)	160 (150 in all subscores)	100	3.0	• B or better in all course work • Statement of purpose • 2 recommendation forms
Real Estate Development											
2-Semester	•	•	30/36	2.75	• 4-year undergraduate degree • 2 years postgraduate full time professional work experience (including business, teaching, military service or government experience)	70 (15 in all subscores)	6.0 (5.5 in all subscores)	160 (150 in all subscores)	100	3.0	• B or better in all course work • Statement of purpose • 2 recommendation forms, preferably one from a School of Business faculty member
1-Semester	•	•	33/36			80 (17 in all subscores)	6.5 (6.0 in all subscores)	170 (160 in all subscores)	110		
Social Work [MSW specializations: Children, Youth, and Families; Adults and Healthy Aging]											
2-Semester	•		54/60	2.75	4-year undergraduate degree or equivalent with 30 credits of general studies or liberal arts course work	70 (15 in all subscores)	6.0 (5.5 in all subscores)	160 (150 in all subscores)	100	3.0	• B or better in all course work • Statement of purpose • 3 recommendation forms
Software Engineering											
2-Semester	•	•	24/30	2.75	• 4-year undergraduate degree or equivalent in computer science or a related field. • Degree must include Data Structures & Algorithms, Automata Theory and Formal Languages and Computer Architecture, including Assembly Language • Completion of Calculus I and II and a discrete mathematics course	65	5.5	155	100	3.0	• B or better in all course work • Statement of purpose • 2 recommendation forms
1-Semester	•	•	24/30			75	6.0	165	110		
Special Education [MEd concentrations: Early Childhood Special Education]											
2-Semester	•	•	21/30	2.75	4-year undergraduate degree or equivalent	70 (15 in all subscores)	6.0 (5.5 in all subscores)	160 (150 in all subscores)	100	3.0	• B or better in all course work • Statement of purpose • 2 recommendation forms
1-Semester	•	•	24/30			80 (17 in all subscores)	6.5 (6.0 in all subscores)	170 (160 in all subscores)	110		
Special Education [No concentration]											
2-Semester	•	•	21/30	2.75	4-year undergraduate degree or equivalent	70 (15 in all subscores)	6.0 (5.5 in all subscores)	160 (150 in all subscores)	100	3.0	• B or better in all course work • Statement of purpose • 2 recommendation forms
1-Semester	•	•	24/30			80 (17 in all subscores)	6.5 (6.0 in all subscores)	170 (160 in all subscores)	110		
Sport and Recreation Studies [MS concentrations: Recreation Administration; Sport and Leisure Studies; Sport Management]											
2-Semester	•		21/30	2.75	4-year undergraduate degree or equivalent	70 (15 in all subscores)	6.0 (5.5 in all subscores)	160 (150 in all subscores)	100	3.0	• B or better in all course work • Statement of purpose • 2 recommendation forms
1-Semester	•		24/30			80 (17 in all subscores)	6.5 (6.0 in all subscores)	170 (160 in all subscores)	110		
Statistical Science											
2-Semester	•	•	24/30	2.75	• 4-year undergraduate degree in any field which includes course work in multivariable calculus, matrix or linear algebra, statistics and calculus-based probability • Students must have completed the equivalent to the following courses: MATH 113, 114, 213, 203 or 321, STAT 250 or 344, 346 or MATH 351 with an equivalent of C or better	65	5.5	155	100	3.0	• B or better in all course work • Statement of purpose • 2 recommendation forms
1-Semester	•	•	24/30			75	6.0	165	110		
Systems Engineering [MS concentrations: Advanced Transportation Systems; Architecture-Based Systems Integration; Command, Control, Communications, Computing, and Intelligence; Energy Systems; Financial Systems Engineering; Systems Engineering and Data Analytics; Systems Engineering of Software-Intensive Systems; Systems Management]											
2-Semester	•	•	24-27/30-33	2.75	• 4-year undergraduate degree in engineering, mathematics, computer science, physical sciences or economics • Completion of multivariate calculus, linear algebra, calculus-based probability and statistics and a computer programming course with an equivalent of B or better required	65	5.5	155	100	3.0	• B or better in all course work • Statement of purpose • Recommendation form
1-Semester	•	•	24-27/30-33			75	6.0	165	110		
Telecommunications [MS concentrations: Network Technologies, Network Forensics and Security]											
2-Semester	•	•	24/30	2.75	4-year undergraduate degree or equivalent	65	5.5	155	100	3.0	• B or better in all course work • Statement of purpose • 2 recommendation forms
1-Semester	•	•	24/30			75	6.0	165	110		

Entry and progression requirements are subject to change and may vary by program.

<sup>1</sup>IELA exam may be required upon arrival, which will determine final study plan.



BRIDGE PROGRAM

The Bridge Program provides two semesters of advanced graduate preparation to students holding a select three-year international undergraduate degree. You can begin taking classes in your master's program while completing general education requirements needed for graduate school at Mason. To view all participating Bridge Programs and entry requirements visit [www.intostudy.com/mason/programs](http://www.intostudy.com/mason/programs)

\* Estimated credits remaining after Pathway/Total credit hours needed to complete degree.

Semester	Start Dates		Credits*	Entry Requirements						Progression Requirements All GPAs are minimum cumulative	
	Fall	Spring		GPA	Relevant UG degree	TOEFL	IELTS	IELA	Duolingo¹	GPA	Other
Business Administration (MBA)											
2-Semester Bridge	•	•	42/48	2.75	<ul style="list-style-type: none"><li>3-year undergraduate degree or equivalent</li><li>The equivalent of two years of postgraduate full-time professional work experience</li><li>Work experience does not need to be business-based and can include teaching, military service or government experience</li></ul>	80 (17 in all subscores)	6.5 (6.0 in all subscores)	170 (160 in all subscores)	110	3.0	<ul style="list-style-type: none"><li>B or better in all course work</li><li>2 recommendation forms</li><li>Statement of purpose</li></ul>
Computer Science											
2-Semester Bridge	•	•	24/30	2.75	<ul style="list-style-type: none"><li>3-year undergraduate degree or equivalent in computer science, computer engineering, software engineering or mathematics</li><li>Degree must include Data Structures and Algorithms, Automata Theory and Formal Languages, Computer Architecture, including Assembly Language</li><li>Must include completion of Calculus I and II and a course in discrete mathematics</li></ul>	75	6.0	165	110	3.0	<ul style="list-style-type: none"><li>B or better in all course work</li><li>Statement of purpose</li><li>2 recommendation forms</li></ul>
Data Analytics Engineering											
2-Semester Bridge	•	•	24/30	2.75	<ul style="list-style-type: none"><li>3-year undergraduate degree or equivalent in engineering, business, computer science, statistics, mathematics or information technology</li><li>Applicants may demonstrate strong work experience with data or analytics instead of related degree</li></ul>	75	6.0	165	110	3.0	<ul style="list-style-type: none"><li>B or better in all course work</li><li>Statement of purpose</li><li>2 recommendation forms</li></ul>
Management											
2-Semester Bridge	•	•	30/36	2.75	3-year undergraduate degree or equivalent	80 (17 in all subscores)	6.5 (6.0 in all subscores)	170 (160 in all subscores)	110	3.0	<ul style="list-style-type: none"><li>B or better in all course work</li><li>2 recommendation forms, preferably one from a School of Business faculty member</li><li>Statement of purpose</li></ul>

<sup>1</sup>IELA exam may be required upon arrival, which will determine final study plan.



"My time here at INTO Mason prepared me for university. I had classes which helped me to adjust to US life and to academics. I felt myself much more open to speak and to express myself. It just made me think in another way."

Sabina, Uzbekistan  
Graduate Pathway in Psychology



ACADEMIC ENGLISH

Our Academic English program prepares you for the university degree by improving your English language skills and providing you with the academic tools you need to succeed. Students like you will learn English in and out the classroom and you will be taught by our qualified and experienced faculty. You will have a chance to practice your English during your everyday life with native speakers. On top of that, you will receive customized support for international students to help you transition to life at a US university.

What You Will Learn

- Understand US values in an academic setting
- Present spoken and written ideas accurately and effectively in English
- Write research papers with proper use of citations and references
- Read, understand and critically evaluate academic texts
- Understand and use vocabulary common to academic disciplines
- Take useful and accurate notes in academic lectures and presentations

Academic Study Plan Calculator

Our Academic Study Plan Calculator will help you estimate your study plan. Simply add your academic program and English scores and receive an estimated study plan showing your duration of study. <https://estimateus.intostudy.com/>

Assured Study Plan

If you submit your TOEFL and IELTS scores before arrival, you won't be required to change to a lower level after taking the Academic English placement tests once you arrive on campus. We will advise you on what level would be best for you based on your English skills. However, after advising you can choose to stay in the level shown on your original study plan.

For more information, visit [into.gmu.edu/programs/academic-english](http://into.gmu.edu/programs/academic-english)



Find out more at  
[www.intostudy.com/mason/academic-english](http://www.intostudy.com/mason/academic-english)

Key Program Facts

- High school diploma required
- Minimum age 17 (students under 17 can be accepted on case-by-case basis)
- No English language requirement; students will be assessed and placed upon arrival
- Program length 16 weeks (11 weeks in Summer)
- 18-20 hours of instruction per week (25 hours in Summer)
- Minimum enrollment 1 semester
- 8 levels of instruction from beginner to advanced

Progression Requirements

International Year One 3-Semester Pathway

Completion of Academic English Core and Oral Communication Skills Level 3 or higher

International Year One 2-Semester Pathway

Completion of Academic English Core and Oral Communication Skills Level 4 or higher

International Year One 1-Semester Pathway and Undergraduate Transfer Program

Completion of Academic English Core and Oral Communication Skills Level 5 or higher

Direct Undergraduate Admission

Completion of Academic English Core and Oral Communication Skills Level 6 or higher

Graduate 2-Semester Pathway

Completion of Academic English Core and Oral Communication Skills Level 5 or higher

Graduate 1-Semester Pathway and Bridge Program

Completion of Academic English Core and Oral Communication Skills Level 6 or higher

Direct Graduate Admission

Completion of Academic English Core and Oral Communication Skills Level 7 or higher

Start Dates for Academic English

Fall 2022	Spring 2023	Summer 2023
Aug 15, 2022	Jan 16, 2023	May 12, 2023



Invest in your degree.  
Invest in your future.  
Invest in you.

Programs

There are two main semesters per academic year (Fall, Spring), each 16 weeks long with a shorter Summer semester of 11 weeks.

With a strong foundation and on-the-job experiences, your education can determine how far you go in your career. Based on your program, you will receive the level of support that corresponds to your academic profile, English language scores and budget.

Whether you're enrolled in our Pathway programs, International Year One, Undergraduate Transfer Program and Academic English, you will have access to our Pre-arrival Success Services and airport pickup when you arrive.

Undergraduate

	International Year One or Undergraduate Transfer Program			Undergraduate Direct	
Program Length	1 Semester	2 Semesters	3 Semesters <small>(Not available for UTP)</small>	1 Semester	2 Semesters
TUITION AND FEES	\$23,810	\$41,420	\$51,940	\$19,200	\$38,040
Housing	\$7,250	\$14,500	\$19,330	\$3,691	\$7,382
Meals	\$3,160	\$6,320	\$8,890	\$2,461	\$4,922
Insurance	\$1,290	\$3,380	\$3,380	\$1,230	\$3,210

Graduate

	Graduate/Bridge Pathway			Graduate Direct	
Program Length	1 Semester	2 Semesters	3 Semesters <sup>1</sup>	1 Semester	2 Semesters
TUITION AND FEES	\$23,810	\$41,420	\$51,940	\$15,250	\$30,500
Insurance	\$1,290	\$3,380	\$3,380	\$1,230	\$3,210

Academic English

Program Length	1 Semester
TUITION AND FEES	\$9,700
Housing	\$7,250
Meals	\$3,160
Insurance	\$1,290

Campus Housing

Undergraduate and Academic English

Single occupancy rooms: **\$10,100**/semester  
Double occupancy rooms: **\$7,250**/semester

*On-campus housing is required for IYO, AE+IYO and UTP students aged 21 and under.* Prices for housing include breaks during the academic year (spring break, holidays, etc.). The estimated cost of books and supplies is \$640 per semester (purchased by student).

Graduate

Single occupancy rooms: **\$10,100**/semester  
Double occupancy rooms: **\$7,250**/semester  
The estimated cost of books and supplies is \$640 per semester (purchased by student).

**Are you an F-1 student?** You will need to provide proof of funding in order to get your I-20. Proof of funding is a way a student shows they have sufficient funds (usually via a recent bank statement) to live and study full-time in the US for up to one academic year. This is different from the cost of attendance OR a statement of account. The proof of funding amount will not be an amount that is billed to you and is solely for immigration purposes. Click here to find out more about proof of finances for immigration purposes. [www.intostudy.com/en/mason/costs](https://www.intostudy.com/en/mason/costs)

Scholarships

 Find out more about scholarships [www.intostudy.com/mason/scholarships](https://www.intostudy.com/mason/scholarships)

		Scholarship Name	Amount	Eligibility & Learn More	Tuition Payable first year <sup>2</sup>
PROGRAM GROUP	INTO George Mason University	Regional Scholarship Undergraduate	Up to \$10,000 on first year	<ul style="list-style-type: none"><li>Fully admitted to an INTO Mason International Year One, Undergraduate Transfer Program or Graduate Pathway/Bridge program</li><li>300-400 word personal statement may be required for some regions</li><li>Scholarship interview may be required for some regions</li><li>Limited availability: first come, first served</li><li>Amount subject to change - limited awards at maximum value</li><li>Contact your INTO regional officer for more information</li></ul>	\$31,420
		Regional Scholarship Graduate	Up to \$10,000 on first year		
		Diversity Scholarship	Up to \$10,000 on first year	<ul style="list-style-type: none"><li>Students who come from diverse and underrepresented backgrounds will automatically be considered for this scholarship</li><li>Qualify for International Year One, Undergraduate Transfer Program or Graduate Pathway/Bridge program and hold letter of offer</li><li>300-400 word personal statement may be required for some regions</li><li>Scholarship interview may be required for some regions</li><li>Limited availability: first come, first served</li><li>Amount subject to change - limited awards at maximum value</li><li>Contact your INTO regional officer or <a href="mailto:intomktg@gmu.edu">intomktg@gmu.edu</a> for more information</li></ul>	\$31,420
		Progression Scholarship Undergraduate	\$9,000 total (\$3,000 per year)	<ul style="list-style-type: none"><li>3.0 - 3.49 GPA upon completion of International Year One or Undergraduate Transfer Program</li><li>The scholarship is renewable for up to 3 years as long as the student maintains a 2.75 GPA during their studies at Mason</li><li>Contact your INTO regional officer or <a href="mailto:intomktg@gmu.edu">intomktg@gmu.edu</a> for more information</li></ul>	\$35,040 <sup>2</sup>
			\$18,000 total (\$6,000 per year)	<ul style="list-style-type: none"><li>3.5 - 4.0 GPA upon completion of International Year One or Undergraduate Transfer Program</li><li>The scholarship is renewable for up to 3 years as long as the student maintains a 2.75 GPA during their studies at Mason</li><li>Contact your INTO regional officer or <a href="mailto:intomktg@gmu.edu">intomktg@gmu.edu</a> for more information</li></ul>	\$32,040 <sup>2</sup>
	George Mason University Direct Entry - Undergraduate	George Mason Undergraduate International Scholarship	Up to \$19,000 per year (renewable annually)	<ul style="list-style-type: none"><li>All directly admitted international students are eligible for an automatic \$3,000 scholarship.</li><li>Direct entry, degree-seeking status</li><li>High academic standing</li><li>Must be non-immigrant and non-resident status in the United States, and on a F-1 visa</li><li>A complete George Mason University freshman application must be submitted by April 1</li><li>SAT required</li><li>For more information, visit <a href="https://www2.gmu.edu/admissions-aid/financial-aid/types-aid/scholarships/mason-scholarships">https://www2.gmu.edu/admissions-aid/financial-aid/types-aid/scholarships/mason-scholarships</a></li></ul>	\$19,040

<sup>1</sup>These are estimated tuition payments assuming a student receives the maximum scholarship value listed for this program.

<sup>2</sup>These are estimated tuition payments when a student starts the degree program after progression from a Pathway.

All prices are estimated from 2021-22 and are subject to change. Please visit [www.intostudy.com/en/mason/costs](https://www.intostudy.com/en/mason/costs) for exact pricing.

**What do students get out of campus housing?**  
Enrich your US university experience by living on campus. See page 6.

For details about Terms and Conditions, Country Scales and English Waivers visit: [www.intostudy.com/mason/terms](https://www.intostudy.com/mason/terms)



# HOW TO APPLY

Choose from two easy ways to apply

**1** Apply via your local  
INTO educational counselor

**2** Apply online  
Complete our online application form:

INTO Mason Programs:  
[apply.intostudy.com/mason](https://apply.intostudy.com/mason)

Direct Undergraduate:  
[www2.gmu.edu/admissions-aid/apply-now](https://www2.gmu.edu/admissions-aid/apply-now)

Direct Graduate:  
[www2.gmu.edu/admissions-aid/apply-now](https://www2.gmu.edu/admissions-aid/apply-now)



## INTO George Mason University

George Mason University  
4400 University Drive, MS 6D11  
Fairfax, VA 22030  
USA

T: +1 703 993 4501  
F: +1 703 993 4502  
E: [INTOadmissions@gmu.edu](mailto:INTOadmissions@gmu.edu)  
Whatsapp: +1 703 935 3981

[www.intostudy.com/mason](https://www.intostudy.com/mason)

## Find us on:



[facebook.com/INTOmason](https://facebook.com/INTOmason)



[instagram.com/INTO\\_mason](https://instagram.com/INTO_mason)



[twitter.com/INTO\\_Mason](https://twitter.com/INTO_Mason)



[myin.to/MasonYouTube](https://myin.to/MasonYouTube)

## WeChat



## Virtual Campus Tour

Take a campus tour from home  
with Mason's Virtual Tour at

[www.youvisit.com/gmu](https://www.youvisit.com/gmu)



Through innovative partnerships with leading universities, we expand opportunities for higher education, ensuring success and transforming the lives of our students and staff.

## INTO GIVING

Working across the globe, INTO Giving supports projects that increase access to education and improve the quality of teaching and learning. For more information, visit [www.into-giving.com](https://www.into-giving.com)

## Discover more online

For counselors:  
[partnerportal.intoglobal.com/gmu](https://partnerportal.intoglobal.com/gmu)

For students:  
[www.intostudy.com/mason](https://www.intostudy.com/mason)

## Connect with us



Education counselor's stamp